

9/5/2014  
8:32:05 AM

Plan Sheet (3/1dgn)  
Plotted By:stewartwillis

PROJECT MANAGER \_\_\_\_\_  
SURVEYED BY, DATE \_\_\_\_\_  
DESIGN BY \_\_\_\_\_  
SUBSURFACE UTILITY BY, DATE \_\_\_\_\_

REVISED	STATE	ROUTE	PROJECT	SHEET NO.
12-9-13 2-19-14	VA.	XXX	XXXX-XXX-XXX, RW-20X,C-50X	7
DESIGN FEATURES RELATING TO CONSTRUCTION OR TO REGULATION AND CONTROL OF TRAFFIC MAY BE SUBJECT TO CHANGE AS DEEMED NECESSARY BY THE DEPARTMENT				
VDOT Location and Design Richmond, Virginia ROADWAY ENGINEER		VDOT Location and Design Richmond, Virginia HYDRAULIC ENGINEER		

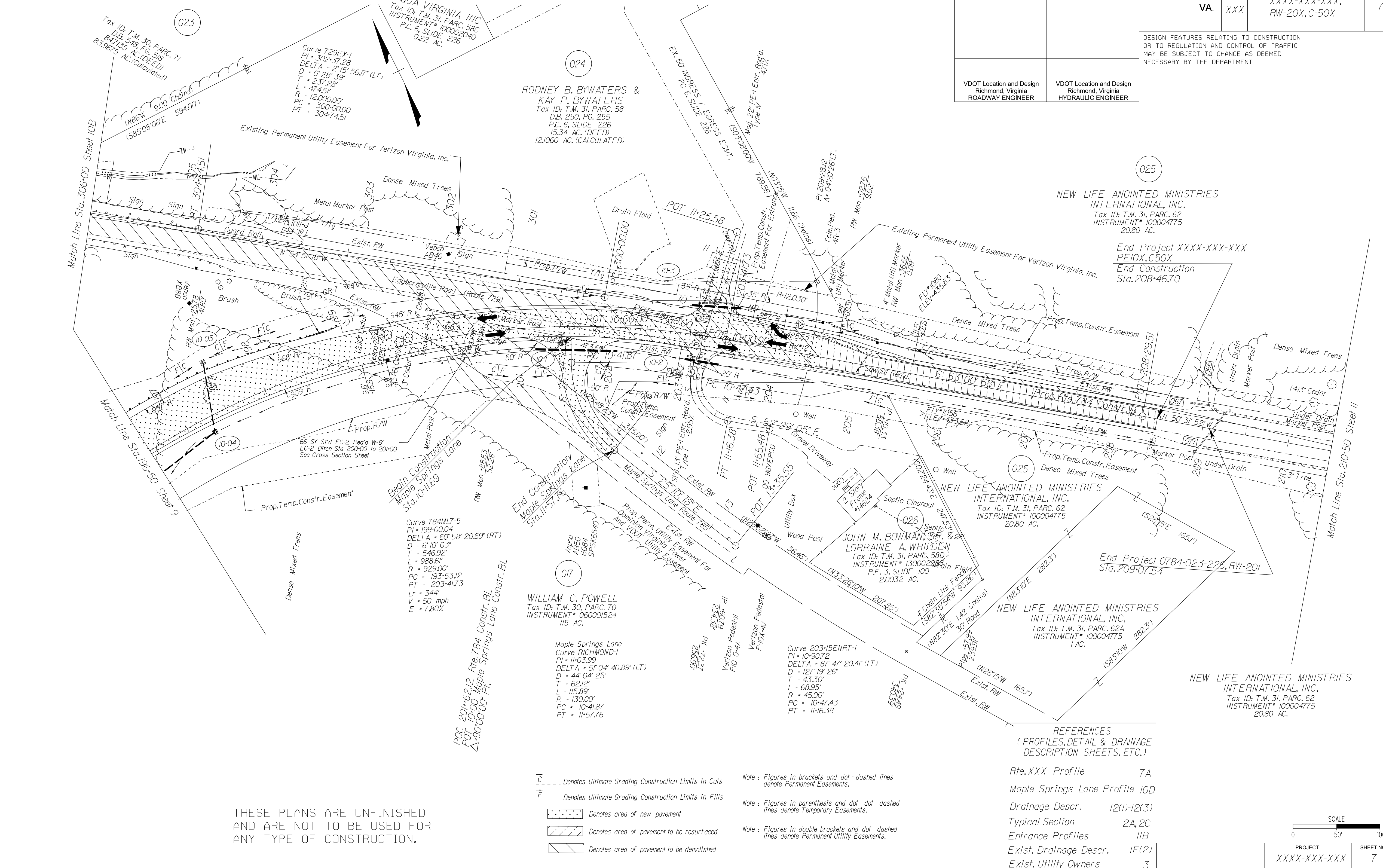

THESE PLANS ARE UNFINISHED  
AND ARE NOT TO BE USED FOR  
ANY TYPE OF CONSTRUCTION.

- C . . . Denotes Ultimate Grading Construction Limits in Cuts
  - F . . . Denotes Ultimate Grading Construction Limits in Fills
  - Denotes area of new pavement
  - Denotes area of pavement to be resurfaced
  - Denotes area of pavement to be demulsified
- Note: Figures in brackets and dot-dashed lines denote Permanent Easements.
- Note: Figures in parenthesis and dot-dashed lines denote Temporary Easements.
- Note: Figures in double brackets and dot-dashed lines denote Permanent Utility Easements.

REFERENCES  
(PROFILES, DETAIL & DRAINAGE DESCRIPTION SHEETS, ETC.)

Rte. XXX Profile	7A
Maple Springs Lane Profile 10D	
Drainage Descr.	(1)(1)-(1)(3)
Typical Section	2A, 2C
Entrance Profiles	11B
Exist. Drainage Descr.	1F(2)
Exist. Utility Owners	3

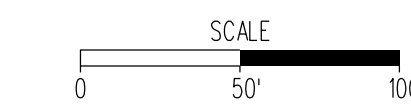

PROJECT	SHEET NO.
XXXX-XXX-XXX	7

FIGURE 2H - 33 SAMPLE 3 PLAN SHEET