

* WATER STOPS TO BE ELASTOMERIC OR OTHER APPROVED MATERIAL. DIMENSIONS SHOWN ARE ABSOLUTE MINIMUM.

EXPANSION JOINTS AT INTERVALS NOT EXCEEDING 90'.

HEIGHT OF WALL "H" IN FEET	THICKNESS AT TOP "A" IN FEET	THICKNESS AT BASE B=4H	COMPRESSION AT TOE LBS. SQ. FT.	AREA OF SECTION SQ. FT.
2	1'-0"	1'-0"	627	2.63
3	"	1'-2 $\frac{3}{8}$ "	1009	3.93
4	"	1'-7 $\frac{1}{4}$ "	1369	5.83
5	"	2'-0"	1709	8.13
6	"	2'-4 $\frac{3}{4}$ "	2049	10.83
7	"	2'-9 $\frac{5}{8}$ "	2385	13.93
8	"	3'-2 $\frac{3}{8}$ "	2720	17.43
9	"	3'-7 $\frac{1}{4}$ "	3054	21.33
10	"	4'-0"	3386	25.63
11	"	4'-4 $\frac{3}{4}$ "	3718	30.33
12	"	4'-9 $\frac{5}{8}$ "	4050	35.43
13	"	5'-2 $\frac{3}{8}$ "	4381	40.93
14	"	5'-7 $\frac{1}{4}$ "	4712	46.83
15	"	6'-0"	5043	53.13

SAFE BEARING CAPACITY OF SOIL	
ROCK MINIMUM	10,000 - 20,000 LBS. SQ. FT.
GRAVEL AND COARSE SAND, WELL CEMENTED.....	16,000 - 20,000 LBS. SQ. FT.
CLAY IN THICK BEDS, ALWAYS DRY.....	12,000 - 16,000 LBS. SQ. FT.
CLAY IN THICK BEDS, MODERATELY DRY.....	8,000 - 12,000 LBS. SQ. FT.
CLAY, SOFT.....	2,000 - 4,000 LBS. SQ. FT.
SAND, DRY, COMPACT, AND WELL CEMENTED.....	8,000 - 12,000 LBS. SQ. FT.
SAND, CLEAN, DRY.....	4,000 - 8,000 LBS. SQ. FT.
ALLUVIAL SOILS, ETC.....	1,000 - 2,000 LBS. SQ. FT.

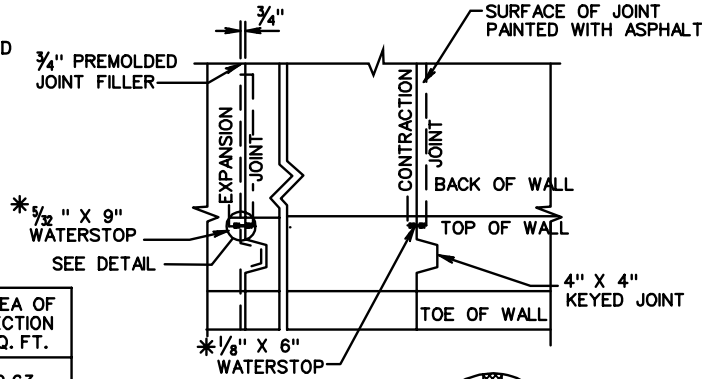

H = HEIGHT IN FT.
 A = 1'
 BASE = 4/10 H
 EARTH = 100 LBS.
 CONCRETE = 150 LBS.
 ANGLE OF REPOSE = 1 1/2: 1

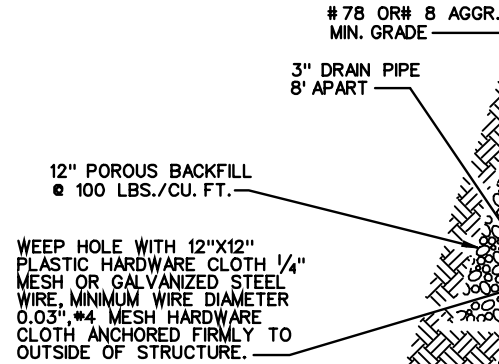
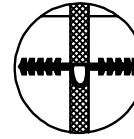

NOTE:
 IF COMPRESSION AT TOE EXCEEDS SAFE BEARING CAPACITY OF SOIL, A SPECIAL FOOTING IS TO BE USED.
 DEPTH OF WALL IN GROUND DETERMINED BY CONDITIONS. TO BE NOT LESS THAN 1'-6".

SPECIFICATION REFERENCE

506

CONCRETE GRAVITY RETAINING WALL - LEVEL BACKFILL

VIRGINIA DEPARTMENT OF TRANSPORTATION

401.01