

**SIZE AND SPACING OF FRACTIONS AND HYPHENS**

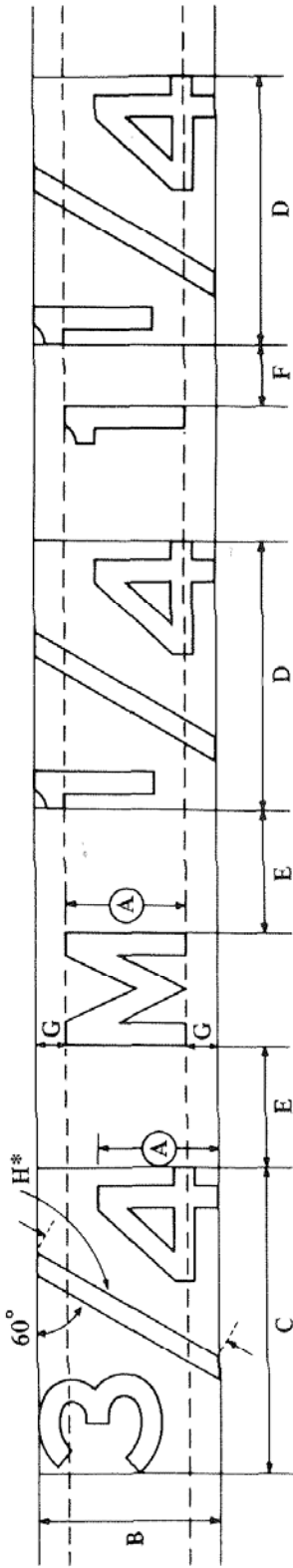

SIZE OF FRACTION RECTANGLE IS DETERMINED AS FOLLOWS:

**LEGEND RATIO TO HEIGHT OF CAPITAL**

A Letter Height	1.0 of Capital
B Height of Rectangle	1.5 x A
C Width of Rectangle	2.5 x A
D Width of Rectangle	2.2 x A
E Space to Next Character	1.0 to 1.5 x A
F Whole Number to a Fraction	.50 to .75 x A
G Space to Top or Bottom of Rectangle	.25 x A
H Length of Diagonal	1.7 x A

\*DIAGONAL STROKE OF FRACTION IS TO BE CENTERED OPTICALLY.

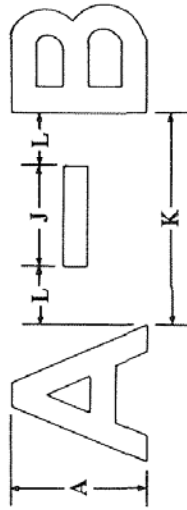

- A Letter Height
- J Length of Hyphen  $A \times .75 = J$
- K Total Width of Hyphen and Spaces  $A \times 2 = K$
- L Space between Hyphen and Letters  $(K - J) \div 2 = L$