

#RDW#  
#RDWLEV#

#REF001  
#REF001LEV001

#REF002  
#REF002LEV002

#REF003  
#REF003LEV003

#REF004  
#REF004LEV004

#REF005  
#REF005LEV005

#REF006  
#REF006LEV006

SURVEYED BY \_\_\_\_\_  
SUPERVISED BY \_\_\_\_\_  
DESIGNED BY \_\_\_\_\_

DESIGN FEATURES RELATING TO CONSTRUCTION OR TO REGULATION AND CONTROL OF TRAFFIC MAY BE SUBJECT TO CHANGE AS DEEMED NECESSARY BY THE DEPARTMENT

NO.	DATE	REVISION	BY	CHKD.
1.				

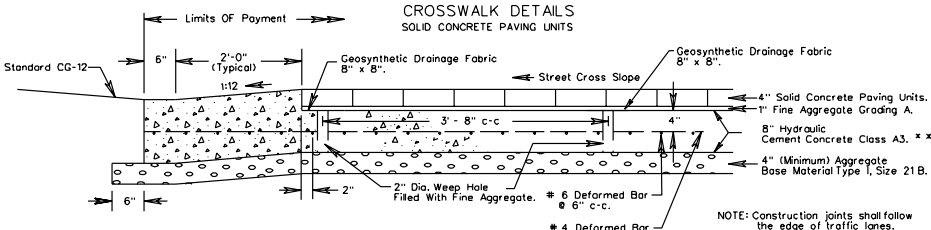
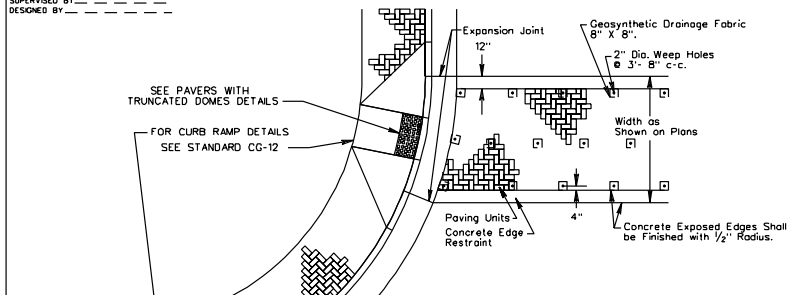

EXPANSION JOINT DETAIL  
LOCATED IN CROSSWALK 30' OR GREATER IN LENGTH

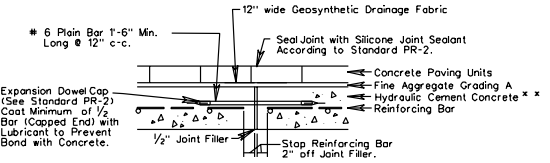

\*\* Optional treatment may consist of a minimum thickness of 8" of asphalt concrete with:

- 6" asphalt concrete base course, type BM-25.0, placed in two lifts.
- 2" asphalt concrete intermediate course, type IM-19.0D.

For this option, adequate drainage and total thickness to support truck traffic must be approved by the Engineer.

NOTE: Expansion Joints Shall be Parallel to the Street Centerline and Located Along the Edge of a Traffic Lane Near the Street Centerline when Possible.

SECTION A-A

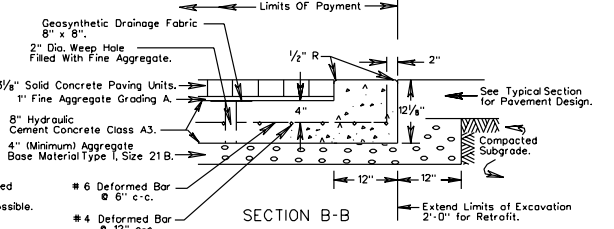

NOTE: Existing pavement to be removed will be removed by saw cutting and excavating as necessary for the placement of the base material, and, will be replaced by new materials directed by the Engineer.

SIDEWALK DETAILS  
SOLID CONCRETE OR BRICK PAVING UNITS

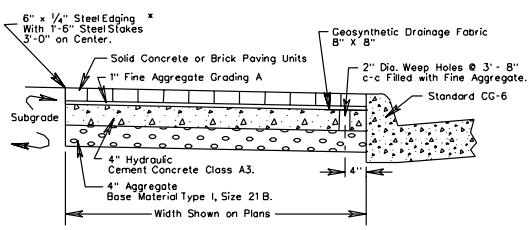

\* Steel Edging may be Deleted Where Sidewalk is Directly Adjacent to Pavement, Curb, etc.; 1/2" Joint Filler and Silicone Sealant Required When Adjacent to Building, Wall or as Directed by the Engineer.

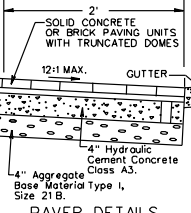
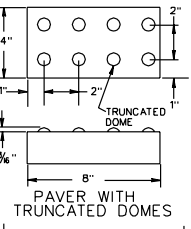

PAVER DETAILS  
SOLID PAVING UNITS (SIDEWALK & CROSSWALK)

MATERIAL SPECIFICATIONS

Solid brick pavers (for sidewalks only) shall conform to ASTM-C-902, Class SX with laboratory testing for resistance to freezing and thawing. A static coefficient of friction of 0.6 is required.  
Solid concrete paving units shall conform to ASTM-C-936 with laboratory testing for resistance to freezing and thawing except lightweight aggregates shall not be used unless specified on the plans. A static coefficient of friction of 0.6 is required.

NOTES:

Color of paving units shall match the color description indicated on the plans. A sample of the paving units to be used shall be submitted and the final color selection shall be approved by the Engineer.  
Joints (except for expansion-joints) between paving units shall be hand tight, sand swept and a maximum of 1/4" wide for concrete and for brick.  
Paving work will be plumb and true to line and grade and shall be installed to properly coincide with adjacent work and elevations. The cutting of the pavers shall be clean with no apparent spalls or breaks.  
Construction joints in the hydraulic cement concrete shall be formed around all appurtenances such as manholes and water meters that extend into or through the crosswalk. These joints shall be filled with 1/2" joint filler and sealed with silicone joint sealant according to Standard PR-2.  
Pattern for paving units shall be a herringbone pattern with 90° angles to the concrete edge restraint or longitudinal edge unless otherwise noted on the plans.  
Paving units shall be placed and vibrated according to manufacturer's recommendations.  
High water table, wet soils or poor soils may require additional drainage as shown on plans or directed by the Engineer.

PAY ITEM

PAY ITEM	PAY UNIT
Sidewalk, Brick Paving Units	Sq. Yds.
Sidewalk, Solid Conc. Pav. Units	Sq. Yds.
Crosswalk, Solid Conc. Pav. Units	Sq. Yds.

METHOD OF MEASUREMENT - SIDEWALK

Sidewalk, solid concrete or brick paving units will be measured in units of square yard, complete-in-place.

BASIS OF PAYMENT - SIDEWALK

The accepted quantities of sidewalk, solid concrete or brick paving units, will include all excavation, aggregate base material, fine aggregate, hydraulic cement concrete, reinforcing joint filler, joint sealant, expansion joints, geosynthetic drainage fabric, steel edging, steel stakes, solid concrete or brick paving units, preparation of subgrade, disposal of surplus material and all incidentals for construction, complete-in-place.

METHOD OF MEASUREMENT - CROSSWALK

Crosswalk, solid concrete paving units will be measured in units of square yard, complete-in-place.

BASIS OF PAYMENT - CROSSWALK

The accepted quantities of crosswalk, solid concrete paving units, will include all excavation, aggregate base material, fine aggregate, hydraulic cement concrete, reinforcing joint filler, joint sealant, expansion joints, geosynthetic drainage fabric, steel edging, steel stakes, solid concrete paving units, preparation of subgrade, disposal of surplus material and all incidentals for construction, complete-in-place.

REV. 3/03  
SPECIAL DESIGN SECTION  
DRAWING NO. A-97

NO.	DATE	REVISION	BY	CHKD.

6/16/02/2/03/03