

5/5/2015  
3:57:11 PM

Plan Sheet Roundabout (4) dgn  
Plotted By: stewartwillis

PROJECT MANAGER \_\_\_\_\_  
SURVEYED BY \_\_\_\_\_  
DESIGN SUPERVISED BY \_\_\_\_\_  
DESIGNED BY \_\_\_\_\_

Utility Owners :

Mr. Art Coleman  
Comcast Cable Communications  
195 Rainville Road  
Winchester, VA 22602  
(540) 504-0942

Mr. John Dalley  
Rappahannock Electric Cooperative  
137 Kelley Court  
Front Royal, VA 22630  
(540) 622-5162

Mr. Steve Heltzel  
Shenandoah Telephone Company  
P.O. Box 459  
Edinburg, VA 22824  
(540) 984-5363

Mr. Rick Boor  
Town Of Berryville  
23 East Main St.  
Berryville, VA 22611  
(540) 955-4843

Mr. Mike Wallace  
Verizon Virginia, Inc.  
404 Hillandale Lane  
Winchester, VA 22602  
(540) 665-3153

Mr. Wayne France  
Washington Gas and Light Company  
350 Hillandale Lane  
P.O. Box 2400  
Winchester, VA 22604  
(540) 868-7923

Mr. Bob Levi  
Clarke County  
County Maintenance Director  
129 Ramsburg Lane  
Berryville, VA 22611  
(540) 955-5123

COUNTY SCHOOL BOARD  
OF CLARKE COUNTY, VIRGINIA  
DB 74 PG 218  
46.79 AC.  
Tax\* 13-A-61

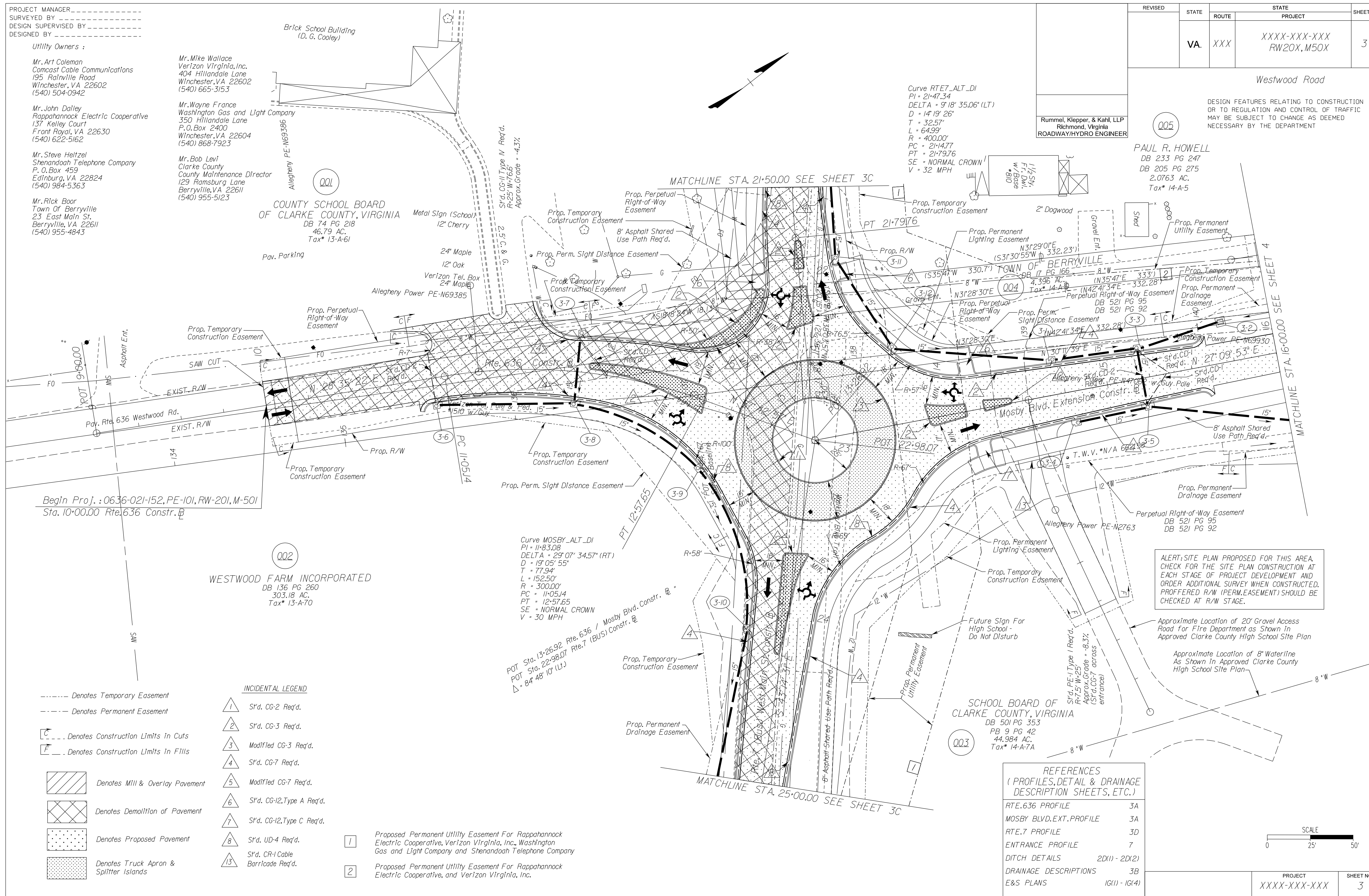

REVISED	STATE	ROUTE	STATE PROJECT	SHEET NO.
	VA.	XXX	XXXX-XXX-XXX RW20X, M50X	3

Westwood Road  
DESIGN FEATURES RELATING TO CONSTRUCTION OR TO REGULATION AND CONTROL OF TRAFFIC MAY BE SUBJECT TO CHANGE AS DEEMED NECESSARY BY THE DEPARTMENT

PAUL R. HOWELL  
DB 233 PG 247  
DB 205 PG 275  
2.0763 AC.  
Tax\* 14-A-5

Rummel, Klepper, & Kahl, LLP  
Richmond, Virginia  
ROADWAY/HYDRO ENGINEER

Begin Proj. : 0636-021-152, PE-101, RW-201, M-501  
Sta. 10+00.00 Rte. 636 Constr. #

WESTWOOD FARM INCORPORATED  
DB 136 PG 260  
303.18 AC.  
Tax\* 13-A-70

Curve MOSBY\_ALT\_DI  
PI = 11-83.08  
DELTA = 29 07' 34.57" (RT)  
D = 19 05' 55"  
T = 77.94'  
L = 152.50'  
R = 300.00'  
PC = 11-05.14  
PT = 12-57.65  
SE = NORMAL CROWN  
V = 30 MPH

- Denotes Temporary Easement
- Denotes Permanent Easement
- C --- Denotes Construction Limits in Cuts
- F --- Denotes Construction Limits in Fills
- [Hatched Box] Denotes Mill & Overlay Pavement
- [Cross-hatched Box] Denotes Demolition of Pavement
- [Dotted Box] Denotes Proposed Pavement
- [Stippled Box] Denotes Truck Apron & Splitter Islands

INCIDENTAL LEGEND

- 1 S'd. CG-2 Req'd.
- 2 S'd. CG-3 Req'd.
- 3 Modified CG-3 Req'd.
- 4 S'd. CG-7 Req'd.
- 5 Modified CG-7 Req'd.
- 6 S'd. CG-12, Type A Req'd.
- 7 S'd. CG-12, Type C Req'd.
- 8 S'd. UD-4 Req'd.
- 13 S'd. CR-1 Cable Barricade Req'd.

- 1 Proposed Permanent Utility Easement For Rappahannock Electric Cooperative, Verizon Virginia, Inc., Washington Gas and Light Company and Shenandoah Telephone Company
- 2 Proposed Permanent Utility Easement For Rappahannock Electric Cooperative, and Verizon Virginia, Inc.

REFERENCES  
(PROFILES, DETAIL & DRAINAGE DESCRIPTION SHEETS, ETC.)

RTE. 636 PROFILE	3A
MOSBY BLVD. EXT. PROFILE	3A
RTE. 7 PROFILE	3D
ENTRANCE PROFILE	7
DITCH DETAILS	2D(1) - 2D(2)
DRAINAGE DESCRIPTIONS	3B
E&S PLANS	1G(1) - 1G(4)

ALERT: SITE PLAN PROPOSED FOR THIS AREA. CHECK FOR THE SITE PLAN CONSTRUCTION AT EACH STAGE OF PROJECT DEVELOPMENT AND ORDER ADDITIONAL SURVEY WHEN CONSTRUCTED. PROFFERED R/W (PERM. EASEMENT) SHOULD BE CHECKED AT R/W STAGE.

Approximate Location of 20' Gravel Access Road for Fire Department as Shown in Approved Clarke County High School Site Plan

Approximate Location of 8" Waterline As Shown in Approved Clarke County High School Site Plan

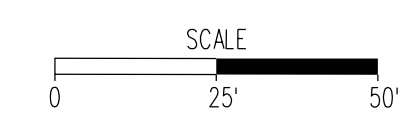

PROJECT	SHEET NO.
XXXX-XXX-XXX	3

FIGURE 2H - 34 SAMPLE 4 PLAN SHEET