

3/25/2011
14:58:44

Figure 2E-13 Title Sheet Primary Design
Plotted By: Stewart/AMIS

FOR INDEX OF SHEETS SEE SHEET 1B

THIS PROJECT WAS DEVELOPED UTILIZING THE DEPARTMENT'S ENGINEERING DESIGN PACKAGE (GEOPAK).
GEOPAK Computer Identification No. 15984



COMMONWEALTH OF VIRGINIA
DEPARTMENT OF TRANSPORTATION

PLAN AND PROFILE OF PROPOSED
STATE HIGHWAY

FAUQUIER COUNTY
FROM: 0.715 MI. SOUTH INT. ROUTE 687
TO: 0.320 MI. NORTH INT. ROUTE 687

FHWA-DATA-12103

LIMITED ACCESS HIGHWAY			
STATE	FEDERAL AID PROJECT	ROUTE	STATE PROJECT
VA.	STP 015-71 (---) See Tabulation Below For Section Numbers	15	(F000015-030-117) See Tabulation Below For Section Numbers

FUNCTIONAL CLASSIFICATION AND TRAFFIC DATA	
NHS-RURAL OTHER PRINCIPAL ARTERIAL-ROLLING-60MPH MIN. DES. SPEED	
Intersection improvements At 15/29 and 17 (Interchange)	
ADT (2006)	42,880
ADT (2035)	73,430
DHV	6,615
D (2) (design hour)	70/30
T (2) (design hour)	Daily (24 hr.) 18% Peak 24%
V (MPH)	*

*See Plan and Profile sheets for Horizontal and Vertical Curve Design Speed

CULPEPER DISTRICT

SUPERVISED BY: *Greg Krasinski* (540) 829-7785
DESIGNED BY: *J.M. Wilson* (804) 786-7727/5M. Smith (804) 225-4872

CONVENTIONAL SIGNS

STATE LINE	---
COUNTY LINE	---
CITY/TOWN OR VILLAGE	---
RIGHT OF WAY LINE	---
POWDER LINE	---
UNFENCED PROPERTY LINE	---
FENCED PROPERTY LINE	---
WATER LINE	---
SANITARY SEWER LINE	---
GAZ LINE	---
ELECTRIC UNDERGROUND CABLE	---
TRAVELER WAY	---
GUARD RAIL	---
RETAINING WALL	---
RAILROAD	---
BASE OR SURVEY LINE	---

LEVELS OR EMBANKMENT	---
BRIDGES	---
CULVERTS	---
ROAD BRIDGE	---
POWER POLES	---
TELEPHONE OR TELEGRAPH POLES	---
TELEPHONE OR TELEGRAPH LINES	---
NEEDLE	---
TRUSS	---
HEAVY WOODS	---
GROUND ELEVATION	---
ORANGE ELEVATION	---

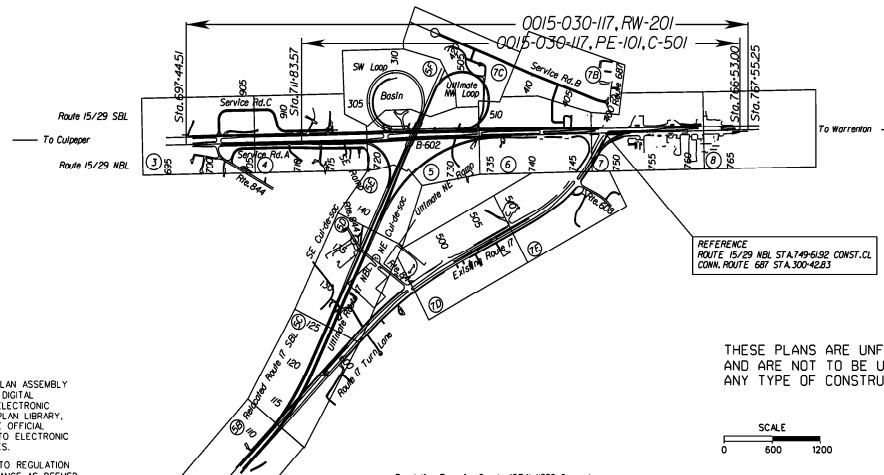

THESE PLANS ARE UNFINISHED
AND ARE NOT TO BE USED FOR
ANY TYPE OF CONSTRUCTION.

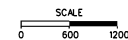

THE COMPLETE ELECTRONIC PDF VERSION OF THE PLAN ASSEMBLY AS AWARDED, HAS BEEN SEALED AND SIGNED USING DIGITAL SIGNATURES AND THE OFFICIAL PLAN ASSEMBLY IN ELECTRONIC FORMAT IS STORED IN THE VDOT CENTRAL OFFICE PLAN LIBRARY. INCLUDING ALL SUBSEQUENT REVISIONS, WILL BE THE OFFICIAL CONSTRUCTION PLANS. FOR INFORMATION RELATIVE TO ELECTRONIC FILES AND LAYERED PLANS, SEE THE GENERAL NOTES.

DESIGN FEATURES RELATING TO CONSTRUCTION OR TO REGULATION AND CONTROL OF TRAFFIC MAY BE SUBJECT TO CHANGE AS DEEMED NECESSARY BY THE DEPARTMENT.

THIS PROJECT IS TO BE CONSTRUCTED IN ACCORDANCE WITH THE DEPARTMENT'S 2007 ROAD AND BRIDGE SPECIFICATIONS, 2008 ROAD AND BRIDGE STANDARDS, 2005 WORK AREA PROTECTION MANUAL AND AS AMENDED BY CONTRACT PROVISIONS AND THE COMPLETE ELECTRONIC PDF VERSION OF THE PLAN ASSEMBLY.

ALL CURVES ARE TO BE SUPERELEVATED, TRANSITIONED AND WIDENED IN ACCORDANCE WITH STANDARD, EXCEPT WHERE OTHERWISE NOTED.

THE ORIGINAL APPROVED TITLE SHEET(S), INCLUDING ORIGINAL SIGNATURES, ARE FILED IN THE VDOT CENTRAL OFFICE PLAN LIBRARY. ANY MISUSE OF ELECTRONIC FILES, INCLUDING SCANNED SIGNATURES, IS ILLEGAL AND ENFORCED TO THE FULL EXTENT OF THE LAW.

Population Fauquier County 48,741 (1990 Census)

STATE PROJECT NO.	SECTION	FEDERAL AID PROJECT NO.	TYPE CODE	PPMS NO.	LENGTH INCLUDING BRIDGE(S)		LENGTH EXCLUDING BRIDGE(S)		BRIDGE PROJECT NO.	TYPE PROJECT	DESCRIPTION
					FEET	MILES	FEET	MILES			
0015-030-117	C-501	NV-STP-030-71	1000	15984	5469.430	1.036	5469.430	1.036		CONST.	From 0.715 M.S. Int. Route 687 To: 0.320 M.N. Int. Route 687
	PE-101	STP-015-71001		15984	5469.430	1.036	5469.430	1.036		PREL. ENGR.	From 0.715 M.S. Int. Route 687 To: 0.320 M.N. Int. Route 687
	RW-201	STP-015-71001		15984	7010.740	1.328	7010.740	1.328		R/W	From 0.988 M.S. Int. Route 687 To: 0.340 M.N. Int. Route 687
	B-602	NV-STP-030-71	X771-SN	15984	203.412	0.039				BRIDGE	Rte. 17 Bridge over Rte. 15/29
	PE-102	STP-015-71001		15984	203.412	0.039				PREL. ENGR.	Rte. 17 Bridge over Rte. 15/29

PROJECT LENGTH BASED ON RTE. 29 NBL CONSTRUCTION BASELINE.

RECOMMENDED FOR APPROVAL FOR RIGHT OF WAY ACQUISITION

TOTAL TAKE FOR PARCELS				
009	009	010	012	013
DATE	PROGRAMMING DIVISION DIRECTOR			
DATE	STATE LOCATION AND DESIGN ENGINEER			
DATE	CHIEF OF PLANNING AND PROGRAMMING			
DATE	CHIEF ENGINEER			

APPROVED FOR RIGHT OF WAY ACQUISITION

DATE	CHIEF OF POLICY AND ENVIRONMENT
------	---------------------------------

RECOMMENDED FOR APPROVAL FOR RIGHT OF WAY ACQUISITION (PARTIAL TAKES)

DATE	PROGRAMMING DIVISION DIRECTOR
DATE	STATE LOCATION AND DESIGN ENGINEER
DATE	CHIEF OF PLANNING AND PROGRAMMING
DATE	CHIEF ENGINEER

APPROVED FOR RIGHT OF WAY ACQUISITION

DATE	CHIEF OF POLICY AND ENVIRONMENT
------	---------------------------------

RECOMMENDED FOR APPROVAL FOR CONSTRUCTION

DATE	PROGRAMMING DIVISION DIRECTOR
DATE	STATE LOCATION AND DESIGN ENGINEER
DATE	CHIEF OF PLANNING AND PROGRAMMING
DATE	STATE STRUCTURE AND BRIDGE ENGINEER

APPROVED FOR CONSTRUCTION

DATE	CHIEF ENGINEER
------	----------------

APPROVED

DATE	VIRGINIA ADMINISTRATOR FEDERAL HIGHWAY ADMINISTRATION U.S. DEPARTMENT OF TRANSPORTATION
------	---

Copyright 2011, Commonwealth of Virginia
PROJECT: 0015-030-117
FILE NO.:
SHEET NO.: 1

FIGURE 2E-13 SAMPLE TITLE SHEET (PRIMARY DESIGN)*

* Rev. 7/11