

“At interchanges, the limited access lines are to encompass the entire periphery of the interchanges and shall extend beyond the ramp terminals to meet the Access Management Standards (Appendix F) for minimum spacing standards for entrances and intersections from interchange ramps.”

- Page 2E-46 – Added the following information on “Surplus Right of Way”;
DETERMINING SURPLUS RIGHT OF WAY

Prior to presenting the plans for public hearing the designer shall designate (with the Residencies concurrence) all areas on the project that are currently existing right of way that can be designated “Surplus Right of Way”. By labeling the surplus in this manner, the surplus property has been established and will be included in the Right of Way Division’s “Residue Parcels Inventory” for disposal purposes.

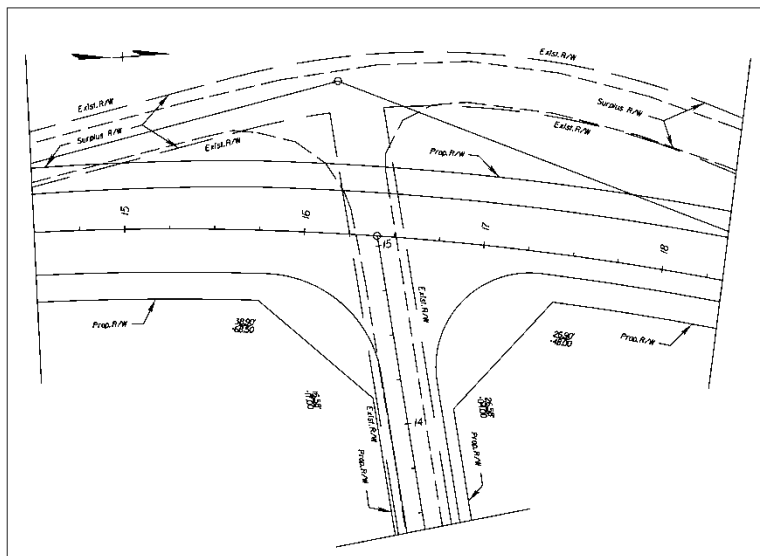

- Page 2E-48 – Revised “FIGURE 2E-9 DEPICTING LIMITED ACCESS RIGHT OF WAY” detail to refer to Appendix F for spacing standards.
- Page 2E-49 – Replaced “FIGURE 2E-10 DEPICTING LIMITED ACCESS RIGHT OF WAY”.
- Pages 2E-50 thru 2E-52 – Replaced the Title Sheet examples with new examples of Tier 1 and Tier 2 projects, page numbers now 2E-50 thru 2E-55.
- Page 2E-72 – Replaced “FIGURE 2E-17 SAMPLE RIGHT OF WAY DATA SHEET to reflect change to add easements for entrances.