

## Width

Buffer strip shall be 48" (1220 mm) wide to provide the lateral offset for the placement of conventional signs in accordance with the MUTCD, Part 2 (See detail below). Buffer strip less than 48" (1220 mm) wide may be utilized; however, a Design Waiver will be required (See IIM-LD-227). In unique situations where **no** buffer strip is provided, (See Sidewalk Width in the following pages),\* additional right of way shall be acquired behind the sidewalk for the placement of lateral obstructions (landscaping, fire hydrants, street lights, parking meters, signal control boxes, signal, sign and utility poles, etc.) as well as proposed drainage structures. The Roadway Designer should coordinate with the Traffic Engineering Designer to determine the amount of right of way necessary.

The Roadway Designer has the option to meander sidewalk or construct a wider sidewalk to accommodate the minimum lateral offset for signs while maintaining a minimum clear width of 5 ft. for the Pedestrian Access Route.

If trees are to be planted in the buffer strip it shall be a minimum 72" (1830 mm) wide and the trees should be planted so that the center of the trees are 36" (914 mm) minimum behind the back of curb.

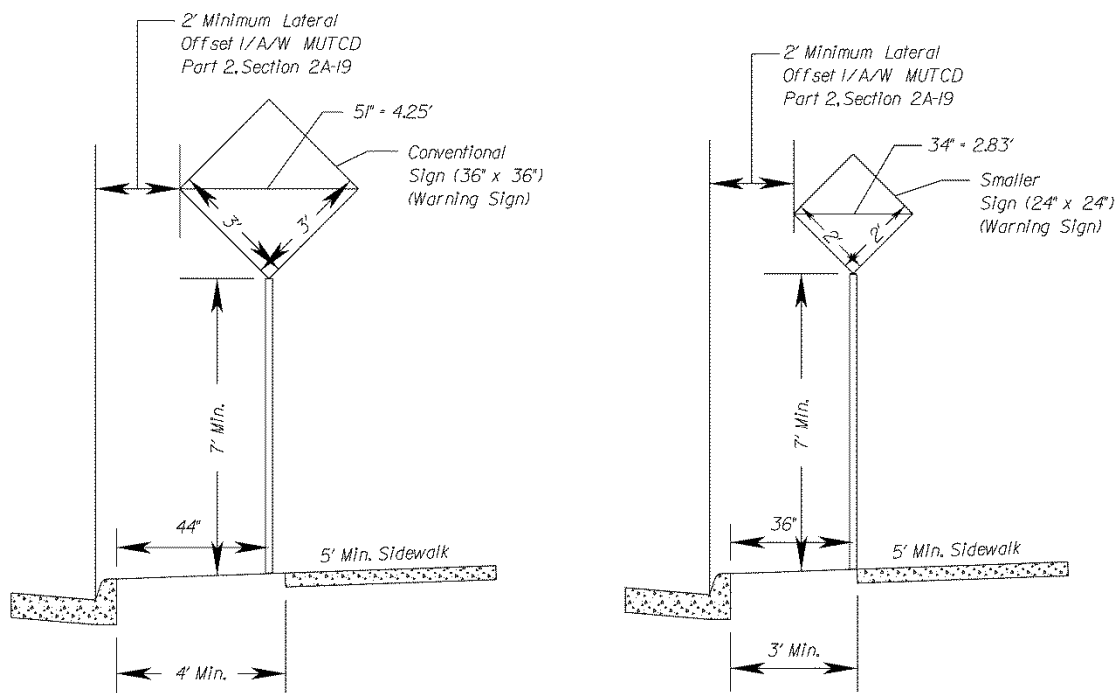

*Typical Urban Projects*  
25 mph Posted Speed  
and Greater

*Subdivision Streets*  
25 mph Posted Speed  
and Less

\* Rev. 1/11