

GR-MGS2

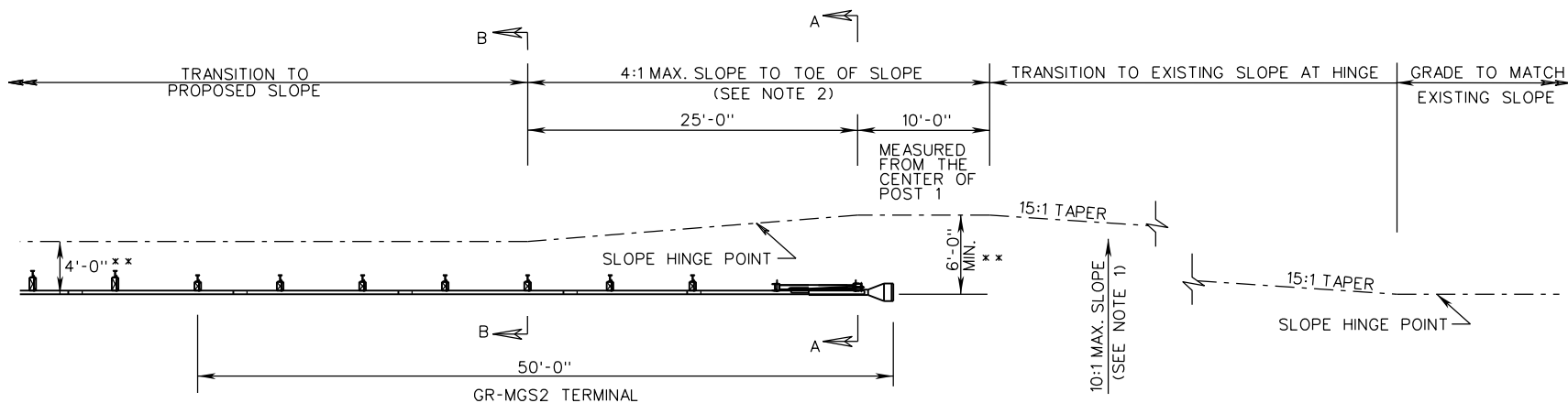

** MEASURED FROM THE FACE OF RAIL

SITE PREPARATION REQUIREMENTS FOR GR-MGS2

NOTES:

1. THE CROSS SLOPE OF THE GRADE APPROACHING THE GUARDRAIL TERMINAL, AND ADJACENT TO FOR ITS FULL LENGTH, MUST BE A MAXIMUM OF 10:1. IF THE EXISTING GRADE IS FLAT OR IS A POSITIVE SLOPE DUE TO THE SUPERELEVATION OF THE ROADWAY PAVEMENT, THE MINIMUM OFFSET FROM THE FACE OF RAIL TO THE HINGE POINT, AS SHOWN, IS REQUIRED.
2. THE AREA IMMEDIATELY BEHIND AND BEYOND THE TERMINAL SHALL BE TRAVERSABLE AND FREE FROM FIXED OBJECTS. IF A CLEAR RUN OUT IS NOT ATTAINABLE THIS AREA SHALL AT LEAST BE SIMILAR IN CHARACTER TO THE UPSTREAM UNSHIELDED ROADSIDE AREAS.
3. FOR NEW CONSTRUCTION AND RECONSTRUCTION, THE 10:1 SLOPE GRADING SHALL EXTEND A MINIMUM OF 6'-0" MEASURED FROM THE FACE OF RAIL.
4. FOR PROPRIETARY GUARDRAIL TERMINALS, THE MANUFACTURER'S SITE PREPARATION REQUIREMENTS TAKE PRECEDENCE OVER THIS STANDARD IF ADDITIONAL GRADING IS REQUIRED.

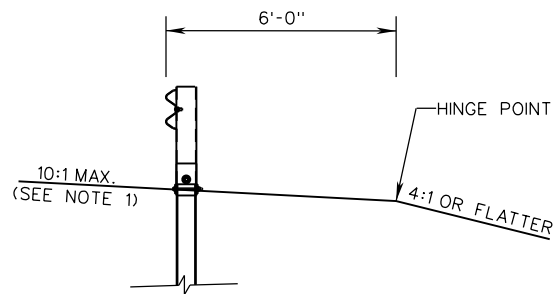

SECTION A-A

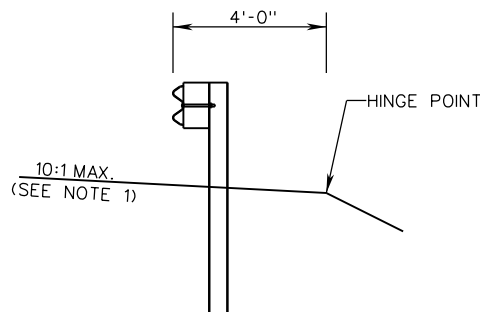

SECTION B-B

A COPY OF THE ORIGINAL SEALED AND SIGNED DRAWING IS ON FILE IN THE CENTRAL OFFICE.

MIDWEST GUARDRAIL SYSTEM
(TANGENT END TERMINAL)

VIRGINIA DEPARTMENT OF TRANSPORTATION

SPECIFICATION REFERENCE

221
236
505



ROAD AND BRIDGE STANDARDS

SHEET 2 OF 3

REVISION DATE

506.07

NEW 02/17