

NOTE:

REINFORCING STEEL BARS SHOWN ARE BASED ON A 20' PANEL LENGTH.

ALL REINFORCING BARS ARE TO BE SIZE #4 GRADE 60 STEEL WITH A MINIMUM 1 1/2" CONCRETE COVER.

THE TYPICAL JOINT SPACING FOR CONSTRUCTION JOINTS IS 20' AND 80' FOR EXPANSION JOINTS FOR TYPE I AND III BARRIERS.

FOR DETAILS OF HOW JOINTS ARE TO BE FORMED & WATER STOPS SEE ST'D. RW-3.

TRANSVERSE JOINTS FOR TYPE I BARRIERS SHALL BE CONSTRUCTED IN ACCORDANCE WITH THE ROAD AND BRIDGE SPECIFICATIONS EXCEPT NO SCORING OR SAWING WILL BE ALLOWED.

HORIZONTAL REINFORCING STEEL BARS B ARE TO BE SEPARATED AT ALL EXPANSION & CONTRACTION JOINTS. A 2" CONCRETE COVER IS REQUIRED OVER THE ENDS OF REINFORCING STEEL.

① TRANSITIONED TO BE PAID FOR AS MEDIAN BARRIER MB-13 TYPE I, II OR III.

② MAXIMUM FLARE RATE FOR RIGID BARRIER SYSTEMS.

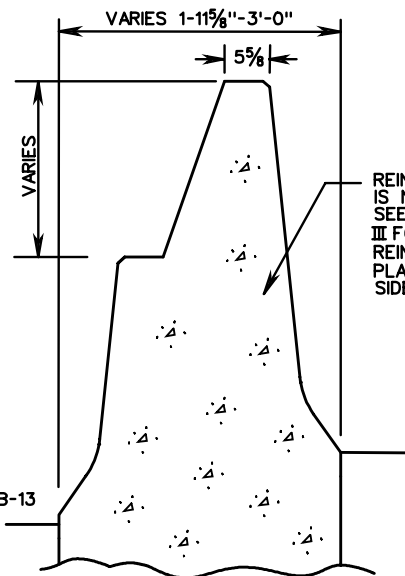

REINFORCING STEEL IS NOT SHOWN SEE TYPE I, II AND III FOR REINFORCING. REINFORCEMENT TO BE PLACED ON HIGHEST SIDE OF TRANS.

SEE APPLICABLE FOUNDATION FOR MEDIAN BARRIER MB-13 TYPE I, II OR III

SECTION A-A
(FOUNDATION NOT SHOWN)

SEE MB-12 FOR DETAILS

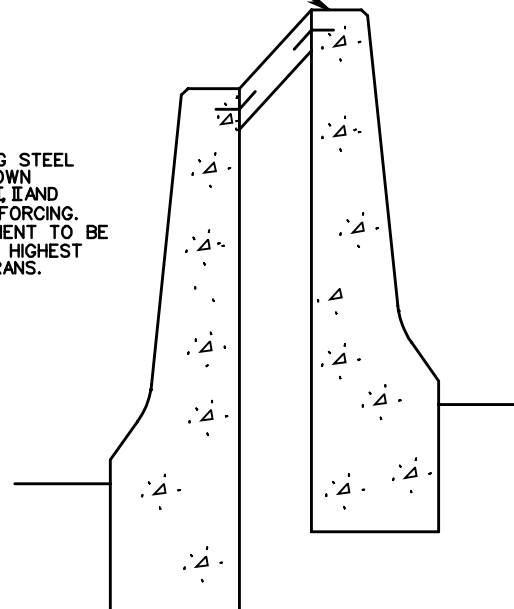

SECTION B-B
(ST'D. MB-12B)

FLARE RATES			
DESIGN SPEED	INSIDE SHY LINE		BEYOND SHY LINE
	SHY LINE LS	FLARE RATE	FLARE RATE
70	10'	30 : 1	20 : 1 ②
60	8'	26 : 1	18 : 1 ②
50	6.5'	21 : 1	14 : 1 ②
40	5'	16 : 1	10 : 1 ②
30	3.5'	13 : 1	8 : 1 ②

SPECIFICATION REFERENCE
105
404
502

**CONCRETE MEDIAN BARRIER
TYPE I, II OR III**

VIRGINIA DEPARTMENT OF TRANSPORTATION