

MB-13

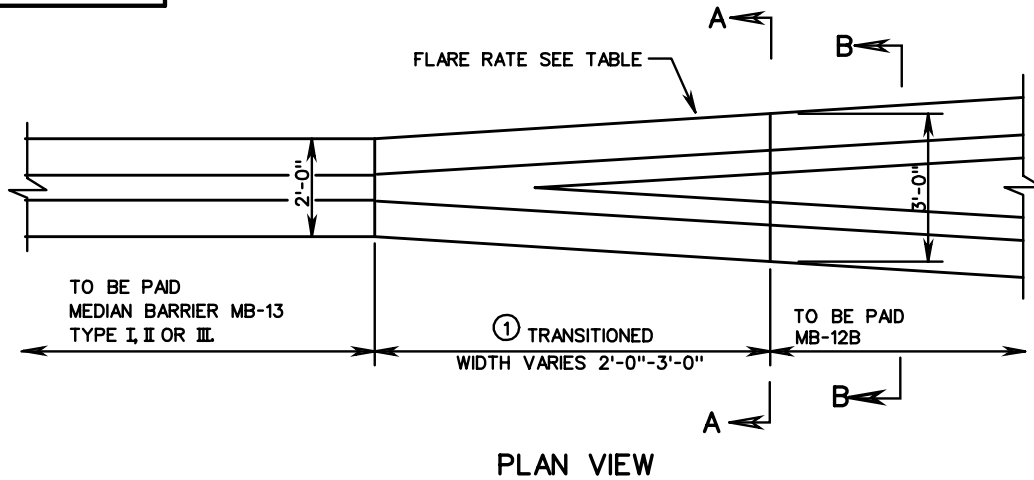

NOTE:

REINFORCING STEEL BARS SHOWN ARE BASED ON A 20' PANEL LENGTH.

ALL REINFORCING BARS ARE TO BE SIZE #4 GRADE 60 STEEL WITH A MINIMUM 1 1/2" CONCRETE COVER.

THE TYPICAL JOINT SPACING FOR CONSTRUCTION JOINTS IS 20' AND 80' FOR EXPANSION JOINTS FOR TYPE II AND III BARRIERS.

FOR DETAILS OF HOW JOINTS ARE TO BE FORMED & WATER STOPS SEE ST'D. RW-3.

TRANSVERSE JOINTS FOR TYPE I BARRIERS SHALL BE CONSTRUCTED IN ACCORDANCE WITH THE ROAD AND BRIDGE SPECIFICATIONS EXCEPT NO SCORING OR SAWING WILL BE ALLOWED.

HORIZONTAL REINFORCING STEEL BARS B ARE TO BE SEPARATED AT ALL EXPANSION & CONTRACTION JOINTS. A 2" CONCRETE COVER IS REQUIRED OVER THE ENDS OF REINFORCING STEEL.

PLAN VIEW

① TRANSITIONED TO BE PAID FOR AS MEDIAN BARRIER MB-13 TYPE I, II OR III.

② MAXIMUM FLARE RATE FOR RIGID BARRIER SYSTEMS.

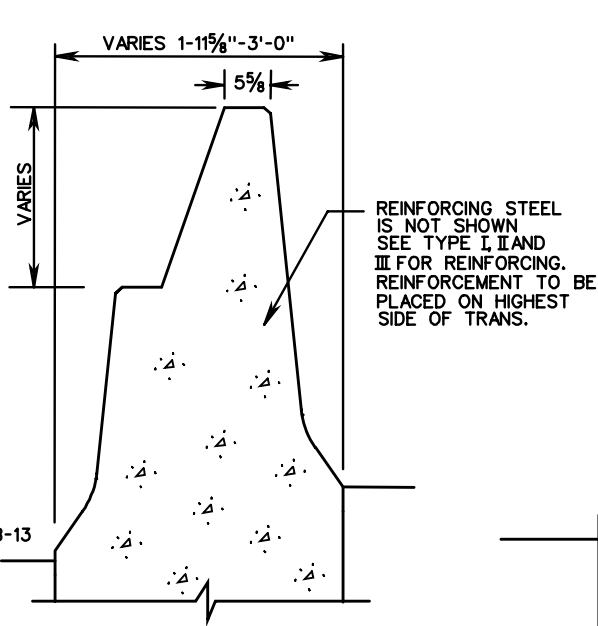

SECTION A-A
(FOUNDATION NOT SHOWN)

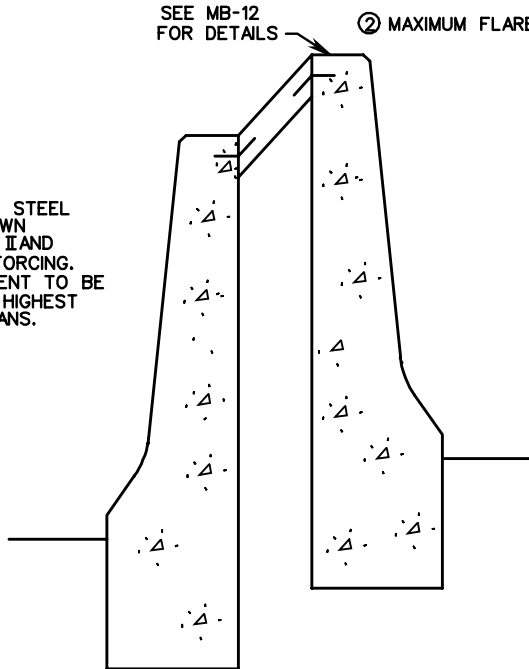

SECTION B-B
(ST'D. MB-12B)

FLARE RATES

DESIGN SPEED	INSIDE SHY LINE		BEYOND SHY LINE
	SHY LINE LS	FLARE RATE	FLARE RATE
70	10'	30 : 1	20 : 1 ②
60	8'	26 : 1	18 : 1 ②
50	6.5'	21 : 1	14 : 1 ②
40	5'	16 : 1	10 : 1 ②
30	3.5'	13 : 1	8 : 1 ②



ROAD AND BRIDGE STANDARDS

SHEET 2 OF 2

REVISION DATE

502.19

CONCRETE MEDIAN BARRIER

TYPE I, II OR III

VIRGINIA DEPARTMENT OF TRANSPORTATION

SPECIFICATION REFERENCE

105
404
502