

6/16/2016
1:58:39 PM

ut4632007.dwg
Plotted By: localuser

PROJECT MANAGER: Catherine Cofey, P.E. (540) 899-4280 (Fredericksburg)
SURVEYED BY: Bion Assoc.
DESIGN SUPERVISED BY: Mikaela Eba, P.E. (804) 371-2772 (CO)
DESIGNED BY: P.K. Das, P.E. (804) 726-4364 (CO)

For Utility Owners, See Sheet 3.

FOR INFORMATION ONLY
SHEET IS NOT TO BE
INCLUDED IN THE
CONSTRUCTION PLAN
ASSEMBLY

REVISED	STATE	ROUTE	PROJECT	SHEET NO.
11/26/13	VA.	630	0630-089-202 RW-201, C-501	7UT
2/19/14				
5/29/14				
7/29/15				
10/05/15				

DESIGN FEATURES RELATING TO CONSTRUCTION OR TO REGULATION AND CONTROL OF TRAFFIC MAY BE SUBJECT TO CHANGE AS DEEMED NECESSARY BY THE DEPARTMENT

VDOT (Division) or Co. Name (Location), Virginia (TECHNICAL DISCIPLINE)	VDOT (Division) or Co. Name (Location), Virginia (TECHNICAL DISCIPLINE)

- 1 Std. CG-7 Req'd
- 2 Std. MS-2 Req'd
- 3 Std. MS-1A Req'd
- 4 Mod. CG-12 Req'd
- 5 10' Shared Use Path Req'd
- 6 5' Sidewalk Req'd
- 11 CG-7 Radial Req'd
- 13 Std. CG-6 Req'd
- 7 Proposed R/W
- 7A Proposed Perpetual Easement
- 8 Prop. Temp. Constr. Ease.
- 10 Prop. Perm. Drainage Ease.
- 15 Prop. Perm. Slope Ease.
- 18 Prop. Perm. VDOT Utility Easement
- 14 Transition from CG-7 to CG-6 from on both sides of Woodcutters Road
- 19 Prop. Perm. VDOT Utility and Dominion Power Easement
- 21 Prop. Perm. VDOT Utility and Columbia Gas Easement

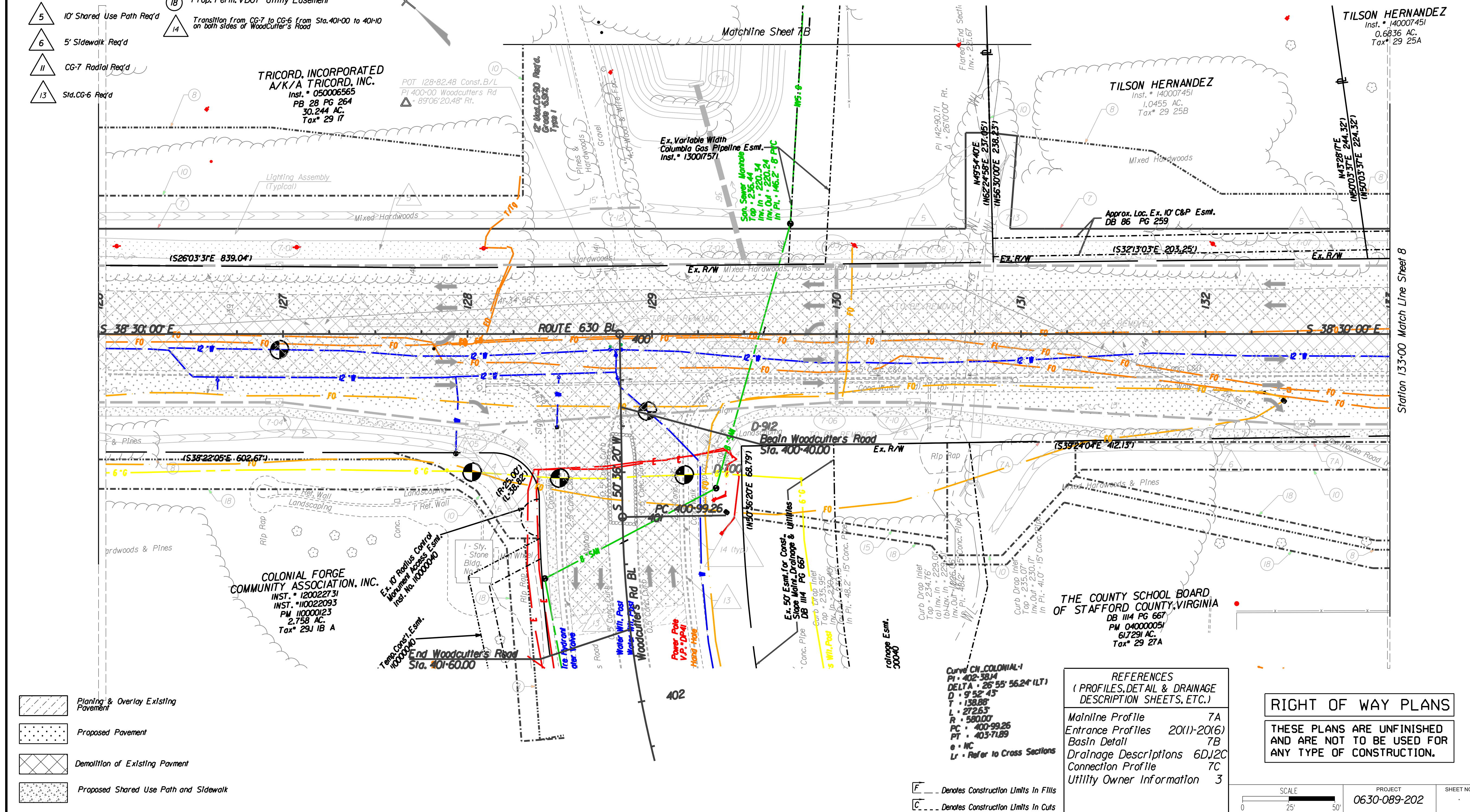

- Planting & Overlay Existing Pavement
- Proposed Pavement
- Demolition of Existing Pavement
- Proposed Shared Use Path and Sidewalk

Curve CH COLONIAL-1
PI 402-38.14
DELTA 26°55'56.2" (LT)
D 952.45
T 138.85
L 272.53
R 580.00
PC 400-99.26
PT 403-71.89
e = NC
Lr = Refer to Cross Sections

REFERENCES
(PROFILES, DETAIL & DRAINAGE DESCRIPTION SHEETS, ETC.)

Mainline Profile	7A
Entrance Profiles	20(1)-20(6)
Basin Detail	7B
Drainage Descriptions	6D, 2C
Connection Profile	7C
Utility Owner Information	3

RIGHT OF WAY PLANS
THESE PLANS ARE UNFINISHED AND ARE NOT TO BE USED FOR ANY TYPE OF CONSTRUCTION.

SCALE	PROJECT	SHEET NO.
0 25' 50'	0630-089-202	

FIGURE 2H-40 SAMPLE UTILITY SHEET