

9/8/2014  
8:28:12 AM

Plan Sheet Roundabout (4) Adj  
Plotted By: stewartwillis

PROJECT MANAGER \_\_\_\_\_  
SURVEYED BY \_\_\_\_\_  
DESIGN SUPERVISED BY \_\_\_\_\_  
DESIGNED BY \_\_\_\_\_

Utility Owners :

Mr. Art Coleman  
Comcast Cable Communications  
195 Rainville Road  
Winchester, VA 22602  
(540) 504-0942

Mr. John Dalley  
Rappahannock Electric Cooperative  
137 Kelley Court  
Front Royal, VA 22630  
(540) 622-5162

Mr. Steve Heltzel  
Shenandoah Telephone Company  
P.O. Box 459  
Edinburg, VA 22824  
(540) 984-5363

Mr. Rick Boor  
Town Of Berryville  
23 East Main St.  
Berryville, VA 22611  
(540) 955-4843

Mr. Mike Wallace  
Verizon Virginia, Inc.  
404 Hillandale Lane  
Winchester, VA 22602  
(540) 665-3153

Mr. Wayne France  
Washington Gas and Light Company  
350 Hillandale Lane  
P.O. Box 2400  
Winchester, VA 22604  
(540) 868-1923

Mr. Bob Levi  
Clarke County  
County Maintenance Director  
129 Ransburg Lane  
Berryville, VA 22611  
(540) 955-5123

COUNTY SCHOOL BOARD  
OF CLARKE COUNTY, VIRGINIA  
DB 74 PG 218  
46.79 AC.  
Tax\* 13-A-61

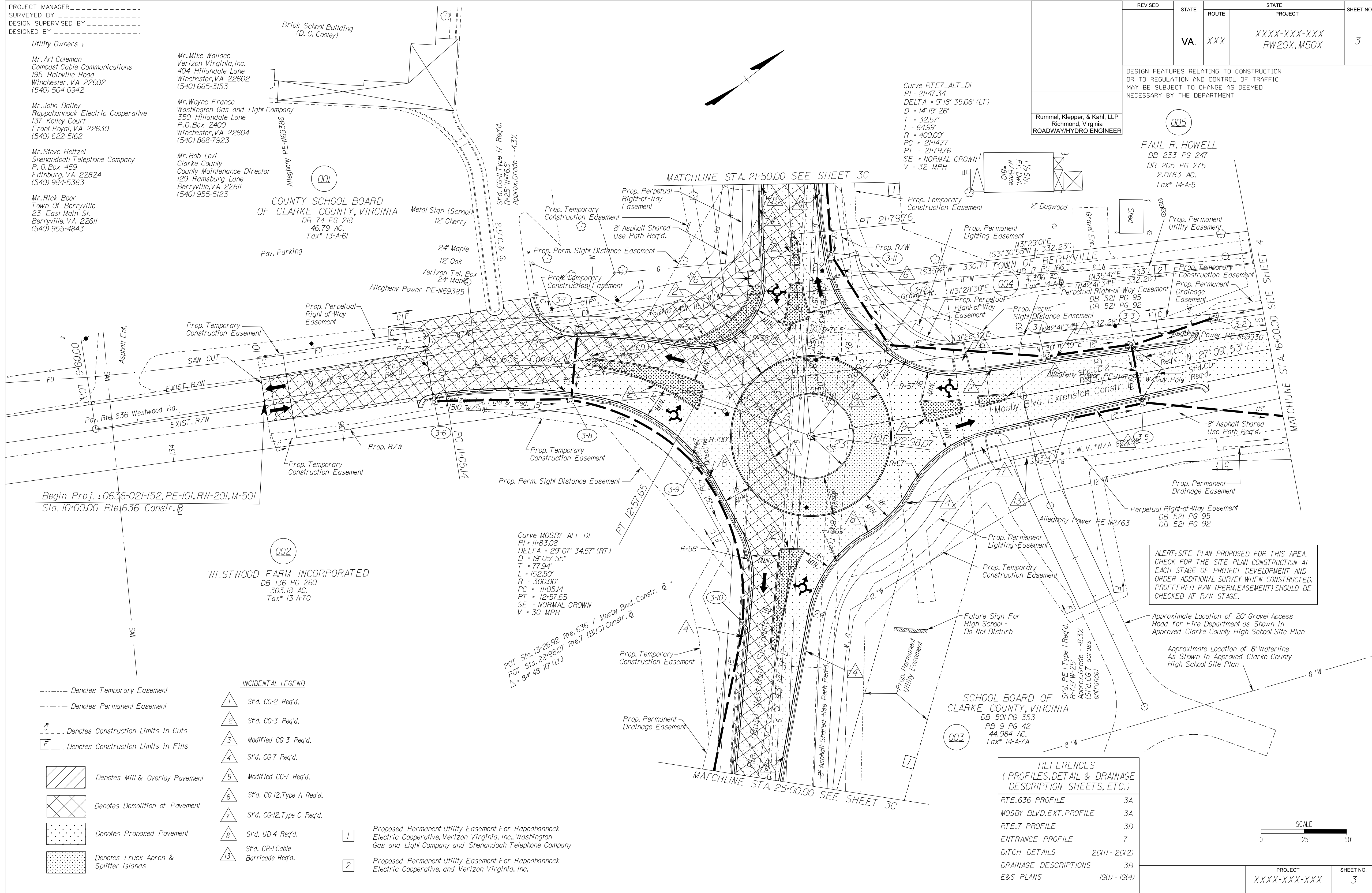

REVISED	STATE		PROJECT	SHEET NO.
	VA.	XXX		
			XXXX-XXX-XXX RW20X, M50X	3

DESIGN FEATURES RELATING TO CONSTRUCTION OR TO REGULATION AND CONTROL OF TRAFFIC MAY BE SUBJECT TO CHANGE AS DEEMED NECESSARY BY THE DEPARTMENT

Rummel, Klepper, & Kahl, LLP  
Richmond, Virginia  
ROADWAY/HYDRO ENGINEER

PAUL R. HOWELL  
DB 233 PG 247  
DB 205 PG 275  
2.0763 AC.  
Tax\* 14-A-5

Begin Proj.: 0636-021-152, PE-101, RW-201, M-501  
Sta. 10+00.00 Rte. 636 Constr.

WESTWOOD FARM INCORPORATED  
DB 136 PG 260  
303.18 AC.  
Tax\* 13-A-70

Curve MOSBY\_ALT\_DI  
PI = 1183.08  
DELTA = 23° 07' 34.57" (RT)  
D = 19' 05' 55"  
T = 77.94'  
L = 152.50'  
R = 300.00'  
PC = 11+05.14  
PT = 12+57.65  
SE = NORMAL CROWN  
V = 30 MPH

Curve RTE7\_ALT\_DI  
PI = 2147.34  
DELTA = 9° 18' 35.06" (LT)  
D = 14' 19' 28"  
T = 32.57'  
L = 64.99'  
R = 400.00'  
PC = 21+14.77  
PT = 21+79.76  
SE = NORMAL CROWN  
V = 32 MPH

- INCIDENTAL LEGEND**
- Denotes Temporary Easement
  - Denotes Permanent Easement
  - C Denotes Construction Limits in Cuts
  - F Denotes Construction Limits in Fills
  - [Diagonal Hatching] Denotes Mill & Overlay Pavement
  - [Cross Hatching] Denotes Demolition of Pavement
  - [Dotted] Denotes Proposed Pavement
  - [Stippled] Denotes Truck Apron & Splitter Islands
  - ▲ S'd. CG-2 Req'd.
  - ▲ S'd. CG-3 Req'd.
  - ▲ Modified CG-3 Req'd.
  - ▲ S'd. CG-7 Req'd.
  - ▲ Modified CG-7 Req'd.
  - ▲ S'd. CG-12, Type A Req'd.
  - ▲ S'd. CG-12, Type C Req'd.
  - ▲ S'd. UD-4 Req'd.
  - ▲ S'd. CR-1 Cable Barricade Req'd.

- [1] Proposed Permanent Utility Easement For Rappahannock Electric Cooperative, Verizon Virginia, Inc., Washington Gas and Light Company and Shenandoah Telephone Company
- [2] Proposed Permanent Utility Easement For Rappahannock Electric Cooperative, and Verizon Virginia, Inc.

ALERT: SITE PLAN PROPOSED FOR THIS AREA. CHECK FOR THE SITE PLAN CONSTRUCTION AT EACH STAGE OF PROJECT DEVELOPMENT AND ORDER ADDITIONAL SURVEY WHEN CONSTRUCTED. PROFFERED R/W (PERM. EASEMENT) SHOULD BE CHECKED AT R/W STAGE.

**REFERENCES**  
(PROFILES, DETAIL & DRAINAGE DESCRIPTION SHEETS, ETC.)

RTE. 636 PROFILE	3A
MOSBY BLVD. EXT. PROFILE	3A
RTE. 7 PROFILE	3D
ENTRANCE PROFILE	7
DITCH DETAILS	2D(1) - 2D(2)
DRAINAGE DESCRIPTIONS	3B
E&S PLANS	1G(1) - 1G(4)

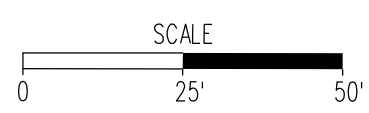

PROJECT	SHEET NO.
XXXX-XXX-XXX	3

FIGURE 2H - 34 SAMPLE 4 PLAN SHEET