

9/5/2014
8:30:28 AM

Plan Sheet (2).dgn
Plotted: Bystewart\jwillis

LIMITED ACCESS HIGHWAY
By Resolution of Commonwealth Transportation Board dated January 17, 1991

PROJECT MANAGER BY _____ Gas Property Of: American Electric Power
SURVEYED BY _____ Columbia Gas of Virginia, Inc. (Transmission)
DESIGNED SUPERVISED BY _____ P.O. Box 6160 Lynchburg, VA, 23405-6160
DESIGNED BY _____ Electric Lines Property Of: American Electric Power Co. P.O. Box 1000 Lynchburg, VA, 24505-1000

UTILITY OWNERS:
Water & Sewer Lines Property Of: City Of Lynchburg
Dept Of Public Works
P.O. Box 60
Lynchburg, VA, 24505
Amherst County Service Authority
P.O. Box 100
Madison Heights, VA, 24572-0100

SWM Entrance Constr. B.L.
DELTA = 91°37'56.40" RT
D = 229'10'59.22"
T = 25.72'
L = 39.98'
R = 25.00'
PC = 11+88.07 (B)
PI = 11+88.07 (B)
PT = 12+28.05 (B)

053
WILLIAM HENRY CHRISTIAN, ESTATE
LUCILLE MCCOY CHRISTIAN, ESTATE
JAMES EDWARD CHRISTIAN
ANNE JACKSON CHRISTIAN
HARRY B. CHRISTIAN
DB231 PG351 & WB135 PG132
PB'C PG27
431.26 AC.

SWM Entrance Constr. B.L.
DELTA = 45°22'11.46" LT
D = 229'10'59.22"
T = 10.45'
L = 19.80'
R = 25.00'
PC = 11+24.72 (B)
PI = 11+35.77 (B)
PT = 11+44.51 (B)

DESIGN FEATURES RELATING TO CONSTRUCTION OR TO REGULATION AND CONTROL OF TRAFFIC MAY BE SUBJECT TO CHANGE AS DEEMED NECESSARY BY THE DEPARTMENT

REVISION	FHWA REGION	STATE	FEDERAL AID PROJECT	ROUTE	STATE PROJECT	SHEET NO.
7/31/98						
2/24/98						
5/5/98						
11/4/98						
6/04/01	3	VA		XXX	XXXX-XXX-XXX, RW-20X C-50X	5
12/07/01						

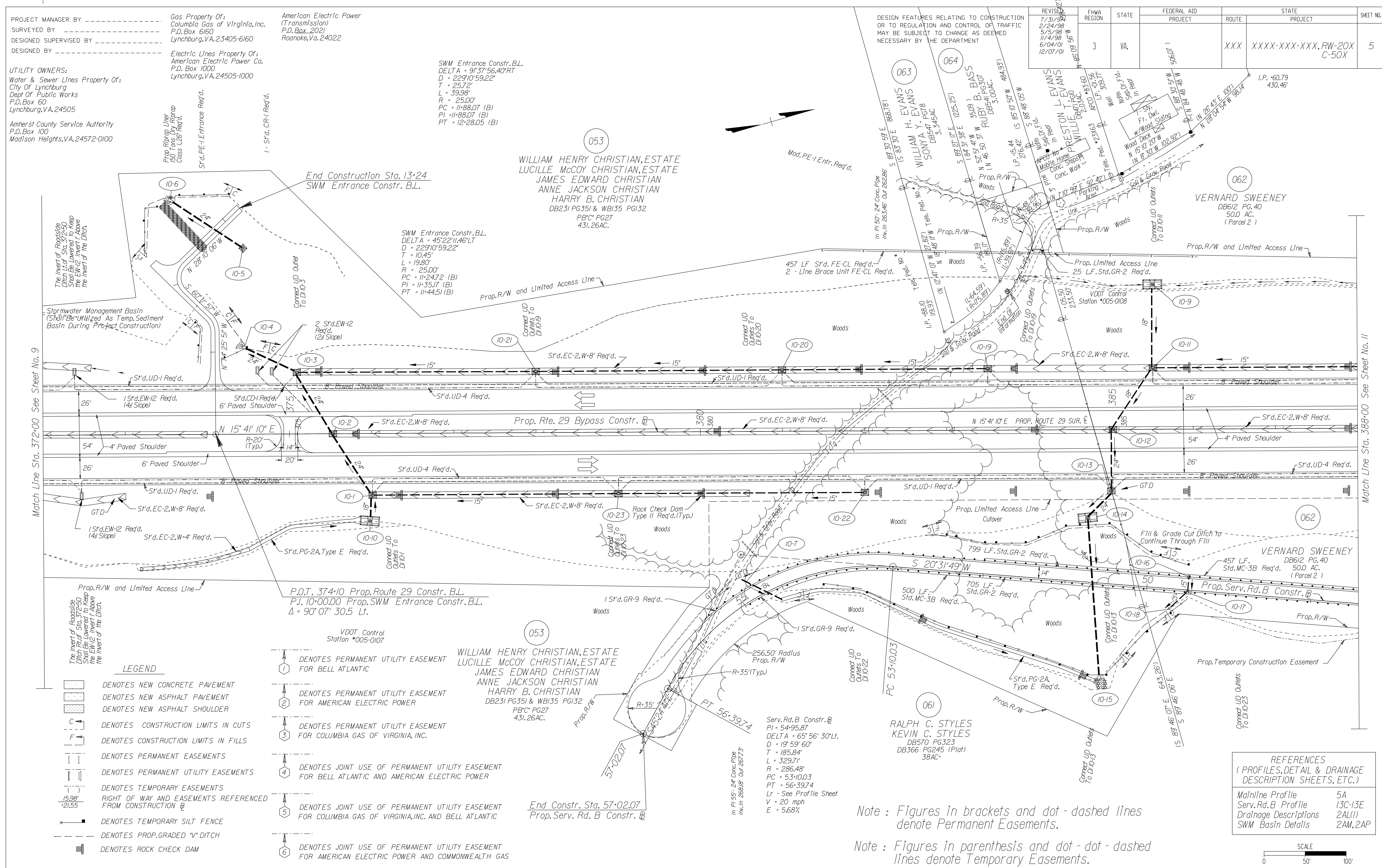

- LEGEND**
- DENOTES NEW CONCRETE PAVEMENT
 - DENOTES NEW ASPHALT PAVEMENT
 - DENOTES NEW ASPHALT SHOULDER
 - DENOTES CONSTRUCTION LIMITS IN CUTS
 - DENOTES CONSTRUCTION LIMITS IN FILLS
 - DENOTES PERMANENT EASEMENTS
 - DENOTES PERMANENT UTILITY EASEMENTS
 - DENOTES TEMPORARY EASEMENTS
 - DENOTES TEMPORARY SILT FENCE
 - DENOTES TEMPORARY SILT FENCE
 - DENOTES PROP. GRADED "V" DITCH
 - DENOTES ROCK CHECK DAM
 - DENOTES PERMANENT UTILITY EASEMENT FOR BELL ATLANTIC
 - DENOTES PERMANENT UTILITY EASEMENT FOR AMERICAN ELECTRIC POWER
 - DENOTES PERMANENT UTILITY EASEMENT FOR COLUMBIA GAS OF VIRGINIA, INC.
 - DENOTES JOINT USE OF PERMANENT UTILITY EASEMENT FOR BELL ATLANTIC AND AMERICAN ELECTRIC POWER
 - DENOTES JOINT USE OF PERMANENT UTILITY EASEMENT FOR COLUMBIA GAS OF VIRGINIA, INC. AND BELL ATLANTIC
 - DENOTES JOINT USE OF PERMANENT UTILITY EASEMENT FOR AMERICAN ELECTRIC POWER AND COMMONWEALTH GAS

REFERENCES
(PROFILES, DETAIL & DRAINAGE DESCRIPTION SHEETS, ETC.)

Mainline Profile	5A
Serv. Rd. B Profile	13C-13E
Drainage Descriptions	2A(1)
SWM Basin Details	2AM, 2AP

Note: Figures in brackets and dot-dashed lines denote Permanent Easements.

Note: Figures in parenthesis and dot-dot-dashed lines denote Temporary Easements.

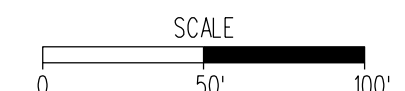

PLAN NO.	PROJECT	FILE NO.	SHEET NO.
A	XXXX-XXX-XXX		5

FIGURE 2H - 32 SAMPLE 2 PLAN SHEET