

In case of skewed culverts, wingwalls conflicting with barrel of proposed extension are to be removed.

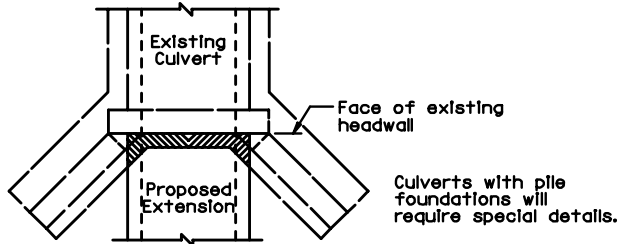
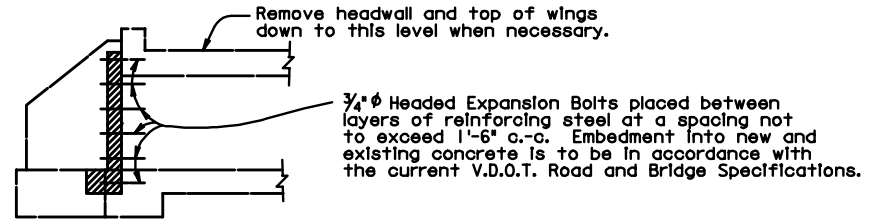
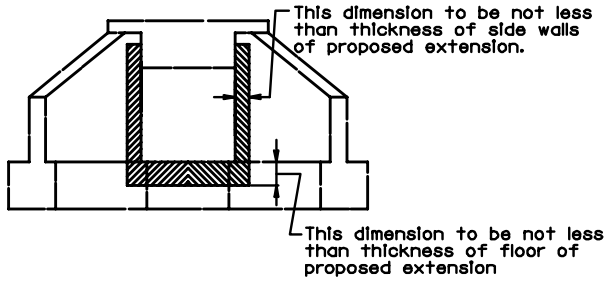

Notes:

Shaded portion indicates existing concrete to be removed, so that all portions of proposed extension will begin in a vertical plane at face of existing headwall. Details of proposed extension including headwall for same can be obtained from box culvert standard. Unit price bid for concrete and reinforcement shall include cost of removal and disposal of old concrete and the furnishing and placing of dowels and expansion bolts required.

**DETAILS FOR WIDENING EXISTING BOX CULVERTS
MODIFICATIONS TO EXISTING BOX**