

SIZE AND SPACING OF FRACTIONS AND HYPHENS

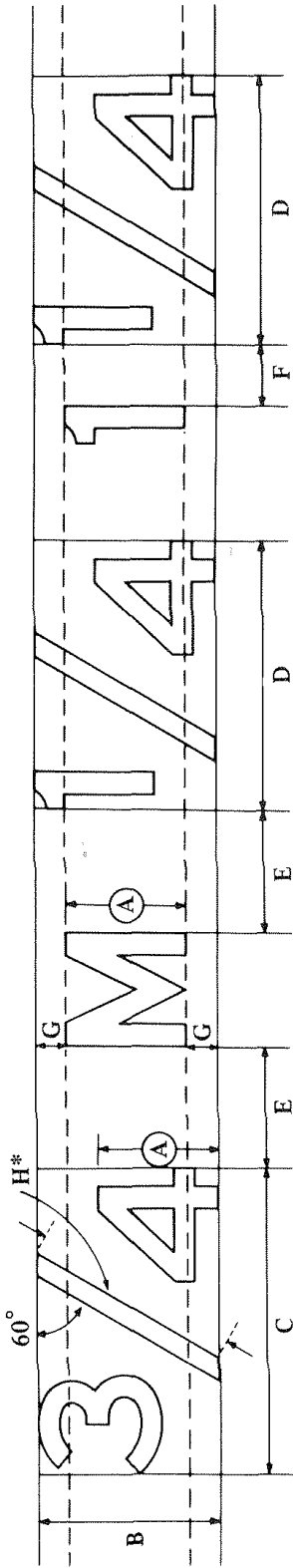

SIZE OF FRACTION RECTANGLE IS DETERMINED AS FOLLOWS:

LEGEND RATIO TO HEIGHT OF CAPITAL

A	Letter Height	1.0 of Capital
B	Height of Rectangle	1.5 x A
C	Width of Rectangle	2.5 x A
D	Width of Rectangle	2.2 x A
E	Space to Next Character	1.0 to 1.5 x A
F	Whole Number to a Fraction	.50 to .75 x A
G	Space to Top or Bottom of Rectangle	.25 x A
H	Length of Diagonal	1.7 x A

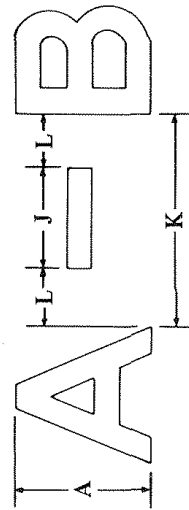

- A Letter Height
- J Length of Hyphen  $A \times .75 = J$
- K Total Width of Hyphen and Spaces  $A \times 2 = K$
- L Space between Hyphen and Letters  $(K - J) \div 2 = L$

\*DIAGONAL STROKE OF FRACTION IS TO BE CENTERED OPTICALLY.