

#RDW8
RODNEY

#REF00
REVD00

#REF002
REVD002

#REF003
REVD003

#REF004
REVD004

#REF005
REVD005

#REF006
REVD006

SURVEYED BY _____
SUPERVISED BY AAA
DESIGNED BY BBB

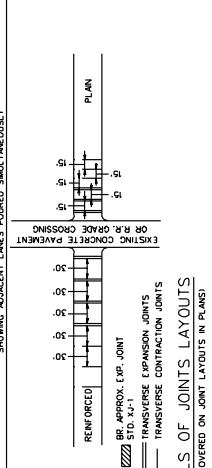
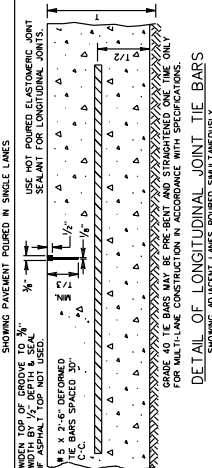
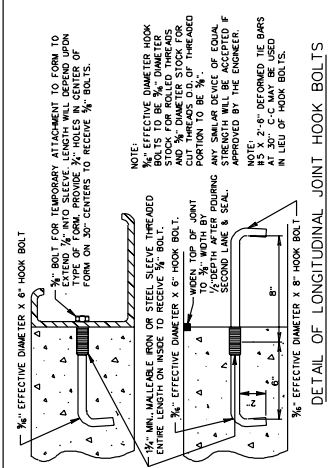
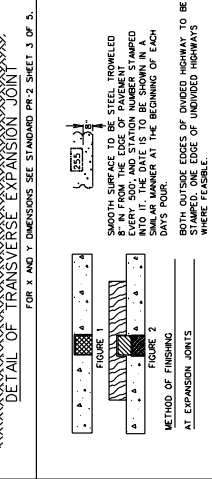
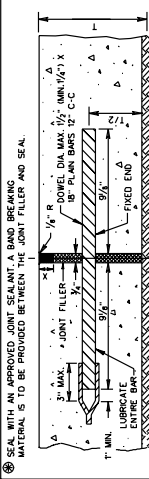
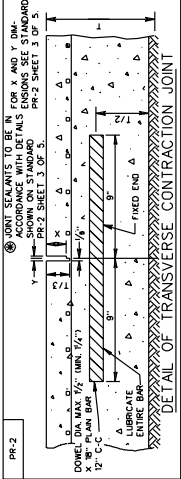

SHEET 2 OF 9
PR-2
30.02
NEW 7/03
REV. 7/03
30.03

PLAIN AND REINFORCED CONCRETE PAVEMENT
SHOWING REINFORCEMENT, LONGITUDINAL AND TRANSVERSE JOINTS

FOR USE WHEN COVERED ON JOINT LAYOUTS IN PLANS

VIRGINIA DEPARTMENT OF TRANSPORTATION

SPECIFICATION
REFERENCE

J16

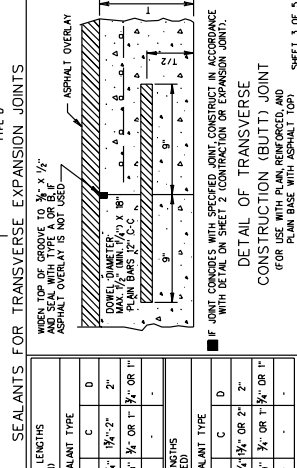
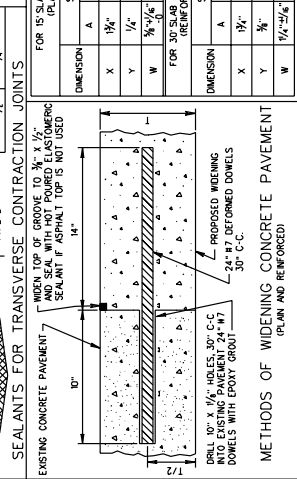
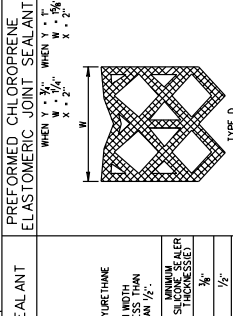
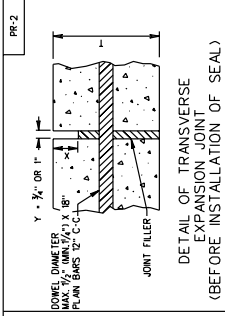
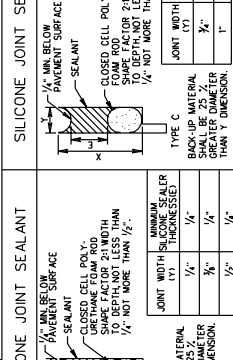
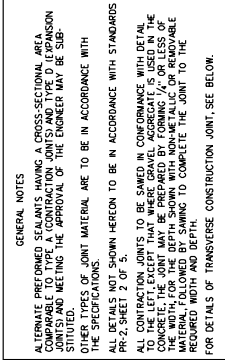
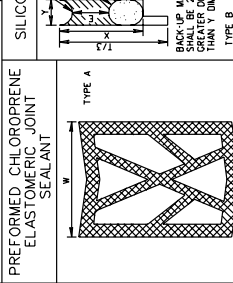
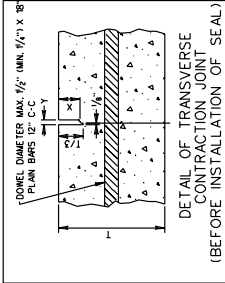

METHODS OF WIDENING CONCRETE PAVEMENT (PLAN AND REINFORCED)
SHEET 3 OF 5
PR-2
30.03
NEW 7/03
REV. 7/03

PLAIN AND REINFORCED CONCRETE PAVEMENT
SHOWING REINFORCEMENT, LONGITUDINAL AND TRANSVERSE JOINTS

VIRGINIA DEPARTMENT OF TRANSPORTATION

SPECIFICATION
REFERENCE

J16

DESIGN FEATURES RELATING TO CONSTRUCTION OR TO REGULATION AND CONTROL OF TRAFFIC MAY BE SUBJECT TO CHANGE AS DEEMED NECESSARY BY THE DEPARTMENT

REVISED	STATE	FEDERAL AID	ROUTE	STATE	SHEET NO.
	VA.				

SPECIAL DESIGN SECTION
DRAWING NO. A-150

PLAN NO.	PROJECT	FILE NO.	SHEET NO.
----------	---------	----------	-----------