

FE-4

HINGES TO BE FORMED OF TRIPLE STRANDS OF MINIMUM #6 GA. GALVANIZED WIRE LOOPED AROUND CABLE AND TOP OF GATE FRAME ON APPROXIMATE 12" CENTERS GATE MUST BE FREE-SWINGING.

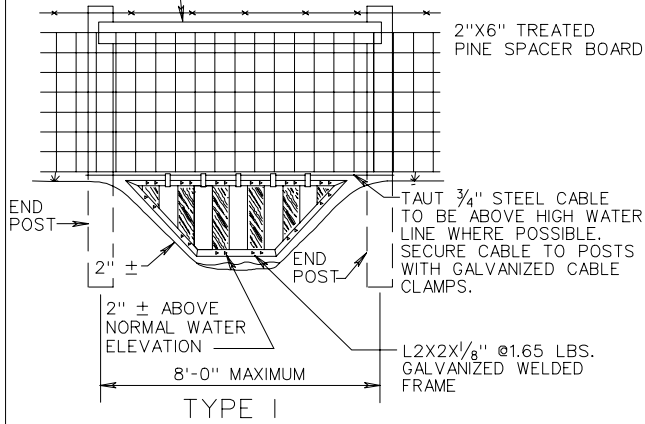

1/2"x10" GALVANIZED NUT, BOLT, 2 PLATE WASHERS, AND 2 LOCK WASHERS.

SHAPE TOP OF POST TO SLIGHT GROOVE. ATTACH TOP RAIL TO POST WITH MINIMUM 2"x1/2"x12 GAUGE GALVANIZED STEEL STRAP. RUN GALVANIZED BOLT THROUGH TOP RAIL AS SHOWN. GATE MUST BE FREE-SWINGING. IF METAL POSTS ARE USED METHOD OF ATTACHMENT IS TO BE APPROVED BY THE ENGINEER.

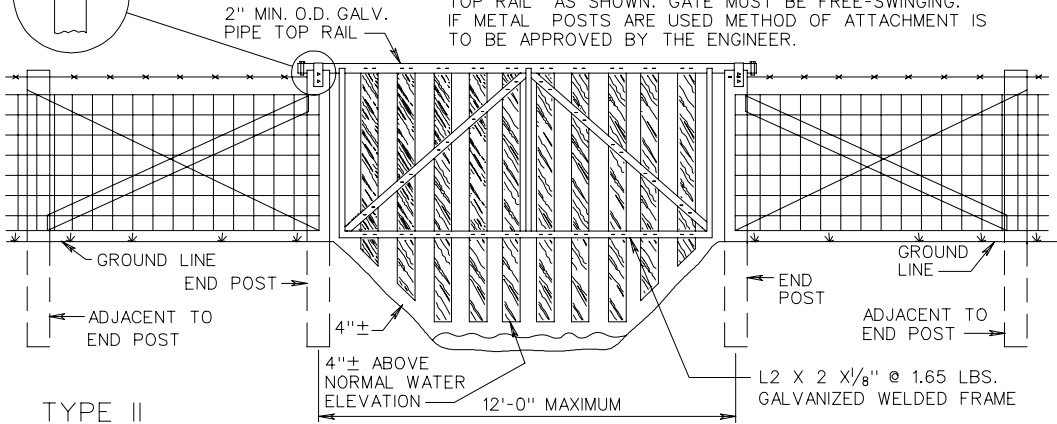

METHOD OF FASTENING FILLER BOARDS TO ANGLE IRON FRAME (TYPE I, TYPE II AND TYPE III)

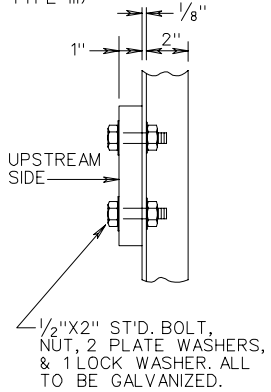

2 BOLT ASSEMBLIES TO BE USED AT EACH INTERSECTION POINT OF FILLER BOARDS AND ANGLE IRON FRAME.

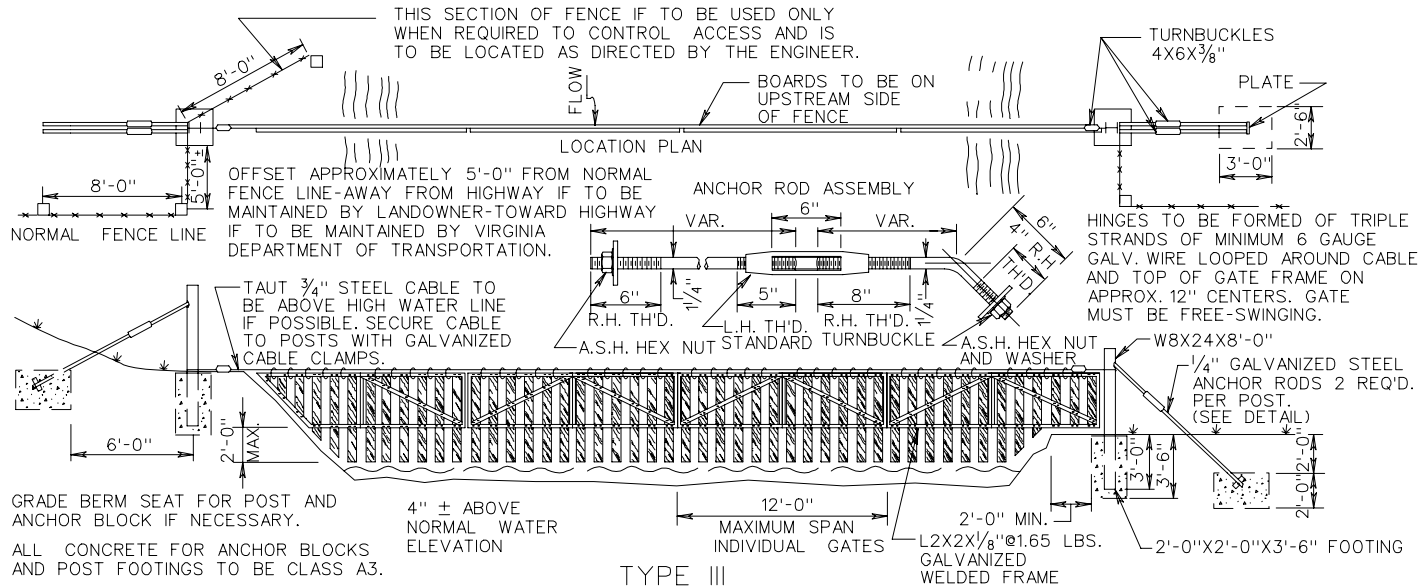

NOTES:
 WATER GATES MAY BE USED WITH STANDARD FE-W1, FE-W2 OR FE-B FENCE.
 GATE IS TO BE FABRICATED TO CONFORM TO INDIVIDUAL CHANNEL REQUIREMENTS.
 WOOD FILLER BOARDS TO BE 1" TREATED PINE BOLTED TO FRAME. SMOOTH WOOD SIDE IS TO FACE UPSTREAM.
 TYPE I GATE IS TO HAVE TWO 8" END POSTS AS SPECIFIED FOR THE TYPE OF FENCE USED. THE ADJACENT TO END POST AND BRACING MAY BE ELIMINATED.
 TYPE II GATE IS TO HAVE TWO 8" END POSTS, ADJACENT TO END POSTS, BRACING, ETC. AS SPECIFIED FOR THE TYPE OF FENCE USED.

WATER GATES IN FENCE LINES

VIRGINIA DEPARTMENT OF TRANSPORTATION

SPECIFICATION REFERENCE

242
 507
 236