

ALL ENDS OPTIONAL CHAMFER (1/2" x 1/2")

POSITIVE CONNECTION

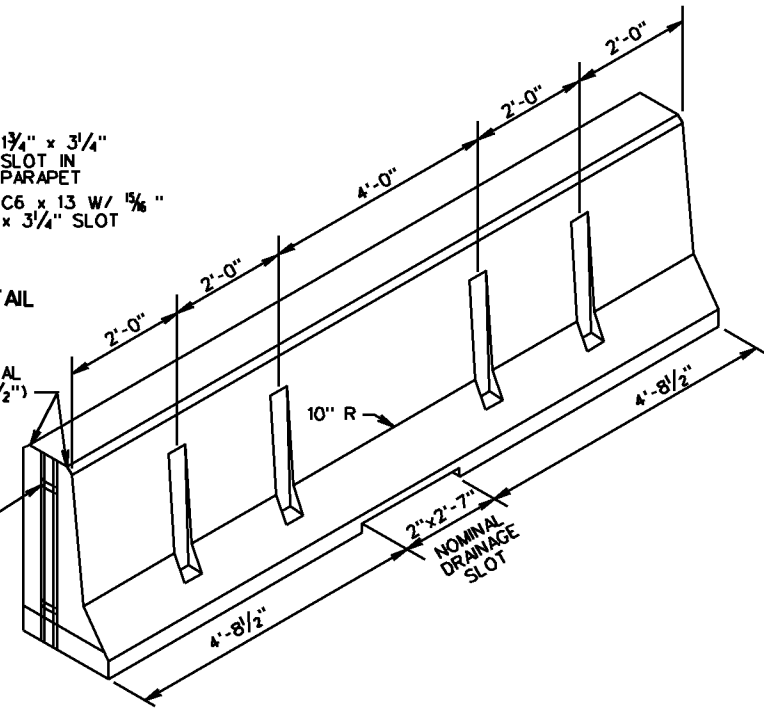

**REINFORCING STEEL SCHEDULE**

FOR ONE (1) SECTION

MARK	No.	SIZE	LENGTH	PIN Ø	LOCATION
TB0401	8	4	1'-5"	—	TEMP. PARAPET
TB0502	12	5	4'-3"	2 1/2"	"
TB0503	12	5	2'-8"	2 1/2"	"
TB0604	8	6	4'-8"	4 1/2"	"

**BENDING DIAGRAM**

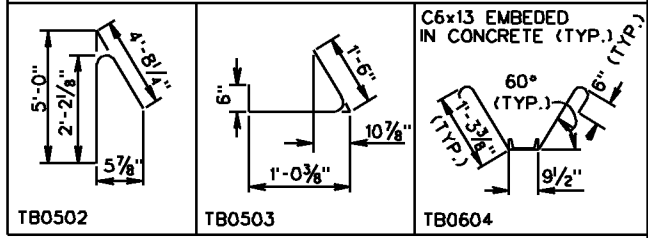

DIMENSIONS IN BENDING DIAGRAMS ARE OUT-TO-OUT OF BARS, EXCEPT AS SHOWN.  
POUNDS OF REINFORCING STEEL = 202  
REINFORCING SCHEDULE BASED ON 12'-0" UNIT LENGTH.

**VDOT**  
ROAD AND BRIDGE STANDARDS

SHEET 1 OF 2  
502.11

REVISION DATE  
01/09

**TRAFFIC BARRIER SERVICE CONCRETE PARAPET (SINGLE FACE)**  
(FOR TEMPORARY INSTALLATION ON BRIDGE DECK EXTERIOR)  
VIRGINIA DEPARTMENT OF TRANSPORTATION

SPECIFICATION REFERENCE

105  
502